

Five Knuckle Standard Weight Series

Recommended for standard weight, medium frequency doors, or doors with closing devices.

- Use for common flush door/frame/wall applications
- For Beveled Edge, where doors are beveled on hinge side, specify TA4314 or TA4714
- For available finishes see page 28

TA2314

TA2714



No.	ANSI Cross Reference	Base Material	Weight
TA2314	A5112	Stainless	STD
TA2314	A2112	Brass	STD
TA2714	A8112	Steel	STD

Specifications

Inches	mm	Gauge	No. of Holes	Fasteners	
				Machine	Wood
3 1/2" x 3 1/2"	88.9 x 88.9	.123	6	1/2 x 10-24	1 x 10
4" x 4"	101.6 x 101.6	.130	8	1/2 x 12-24	1 1/4 x 12
4 1/2" x 4"	114.3 x 101.6	.134	8	1/2 x 12-24	1 1/4 x 12
4 1/2" x 4 1/2"	114.3 x 114.3	.134	8	1/2 x 12-24	1 1/4 x 12
5" x 4 1/2"	127 x 114.3	.146	8	1/2 x 12-24	1 1/4 x 12
5" x 5"	127 x 127	.146	8	1/2 x 12-24	1 1/4 x 12
6" x 6"	152.4 x 152.4	.160	10	1/2 x 1/4-20	1 1/2 x 14

*Not available in Brass base material.

Options:

Code	Description
NRP	Non-Removable Pin
TB	Ball Bearing
TCA	Concealed Bearing
RC	Round Corner – 1/4" radius furnished unless specified otherwise
HT	Hospital Tip
BT	Ball Tip
FT	Flat Tip*

Code	Description
GT	Grooved Tip*
LT	Lined Tip*
RT	Round Tip*
ST	Steeple Tip
SSF	Safety Stud Feature
CC	Concealed Circuit – 4, 8, or 12 wire available

Code	Description
CC-18	Concealed Circuit – 2, 4, 6, 8 or 10 wire available (2-18AWG wires and the remainder 28AWG wires)
MM	Magnetic Monitoring
QC	ElectroLynx® Hinge – 4, 8 or 12 wire available

*Not available on 3-1/2" and 6" sizes

McKinney Hinge Pin Door Stop

- Recommended for high-use or high impact doors with McKinney T2714 or TA2714 hinges
- Protects against damage to doors and walls
- Runs the full length of the hinge

Part number	Description	Finish
76305	Hinge Pin Stop for MacPro MP79 & MPB79	26D
76306	Hinge Pin Stop for McKinney T2714 & TA2714	26D



ASSA ABLOY
Opening Solutions

Experience a safer
and more open world

800-346-7707 | www.assaabloydooraccessories.us
Check the web site for the up-to-date catalog

McKinney is a brand associated with ASSA ABLOY Accessories and Door Controls Group, Inc., an ASSA ABLOY Group company. Copyright © 2012-2019, ASSA ABLOY Accessories and Door Controls Group, Inc. All rights reserved. Reproduction in whole or in part without the express written permission of ASSA ABLOY Accessories and Door Controls Group, Inc. is prohibited.

Model 127-3/4

Application

Interior Doors
Weight to 200 lbs.
Door Sizes up to 3'6" x 8'6"
(1067 x 2591mm)
Non-handed

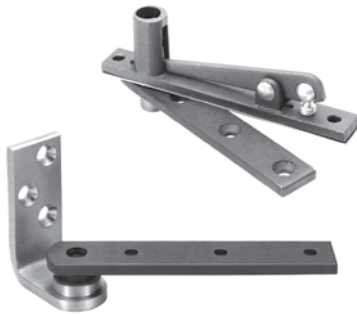

Product Description & Features

- Standard top pivot 320 included
- Bottom pivot mortised into side jamb
- Weight of door borne by floor
- Pivot point centered in thickness of door
- Door must have radius on pivot edge
- Not allowed for use on labeled doors and frames
- Furnished with wood and machine screws
- Available with extended spindles in 1/2" (13mm) increments up to 2" (51mm) longer than standard

Technical Information

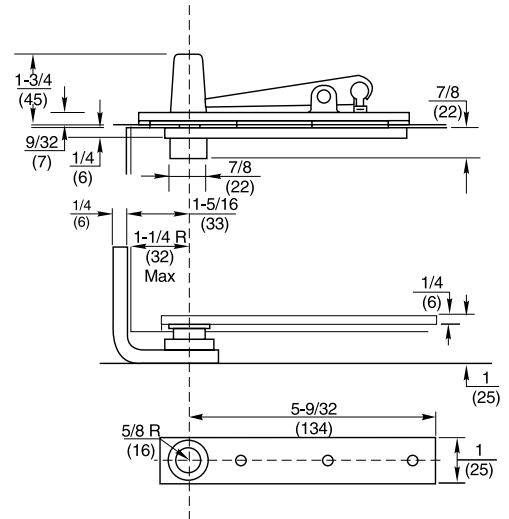

BHMA/ANSI NO: C07042

Center hung pivots are door hanging means only. To close doors see floor closer sections of the catalogs.

Model 128-3/4

Application

Interior Doors
Weight to 250 lbs.
Door Sizes up to 3'6" x 8'6"
(1067 x 2591mm)
Non-handed

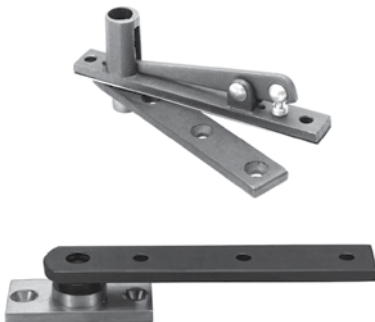

Product Description & Features

- Identical to the 127-3/4 except:
- Bottom pivot mounts directly to floor

Technical Information

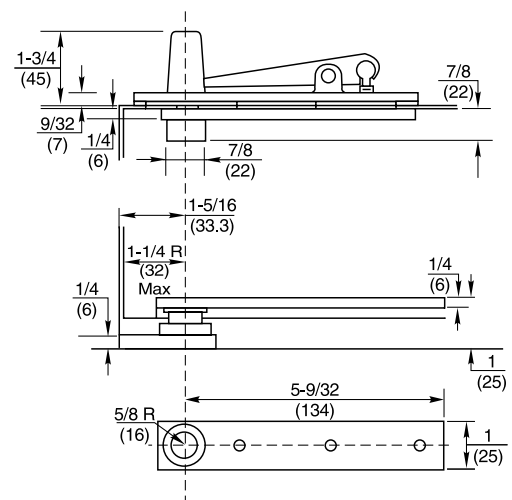

BHMA/ANSI NO: C07032

Center hung pivots are door hanging means only. To close doors see floor closer sections of the catalogs.

Options

Fire Rated – Prefix F

Pivots for fire rated doors (*up to 3 hours*) include a steel top pivot and must have additional steel intermediate pivots. For F519 pocket pivot, door assemblies must have been tested with pocket pivots.



Twenty-minute label – Suffix - 20

This UL rating is for 20-minute assemblies.

Product with this rating has an authorized label.



Handing

All offset pivots and pivot sets are handed.

Suffix RH or LH.

Extended Spindle – Suffix extra length needed

Any special coverings or severe door undercuts will affect the spindle height. In these applications, an extended spindle may be required. Most standard spindle heights accommodate door undercuts up to 1/2". Extended spindles available in 1/2" increments up to 2" longer than standard. See template.

1-1/2" Offset – Suffix 1-1/2

Offset is the distance from the face of the door to the pivot point. Extended offsets should not be used unless there is cladding on the face of the door or there is trim to clear on the frame. 1-1/2" offset arms and pivots are for doors with cladding or trim that project 3/4" from the face of the door. The greater the offset the less weight can be carried by the pivot.

Less Top Pivot – Suffix LTP

For conditions requiring special top pivots or for arch top doors, the pivot set should be ordered less top pivot – LTP. For offset installations an additional load bearing intermediate (side jamb) M190 pivot is required. All intermediate pivots for that opening should be M190's, not M19's.

Special Layouts – Suffix SPLO#

Unique installations or specially engineered products are called special layouts. These numbers must be assigned by the technical support department and they must be called out specifically by their number when ordering.

Door Thickness – Suffix 1-3/4", 2", 2-1/4", 2-1/2" or 3"

When ordering L series pivot for lead-lined doors, the thickness of the door must be given. The purpose of the L product is to have screws spaced so they straddle the lead in the center of the door. Also used when lead lining is under the skins of the door. Recommended for use on extra heavy or high traffic doors.

Pivots and Pivot Sets Options, Certifications Limited Warranty, Specifications

ElectroLynx® Connectors – Suffix QC – Number of Wires

The plug-in connectors with easy color coded wire system eliminate matching wires. Must be used with ASSA ABLOY doors, frames and hardware. Available 4, 6, 8 or 12 wires for most products.

Hardwiring Made Easy®



Certifications

All Rixson® pivots and pivot sets are in compliance with ANSI/BHMA 156.4 Standards. See individual products for sub sections.



Limited Warranty

Rixson Pivot sets are warranted for 2 years for defect. See Rixson Price Book for specific details of the limited warranty.

Specifications

All pivots and pivot sets shall be of one manufacturer. All heavy-duty pivots shall have a minimum of 2 bearings internal to the bottom pivot. One shall be a thrust bearing and the other a needle bearing. Separate bearing surfaces shall be in the top pivot. Lead-lined door units and high traffic pivots shall have additional thrust bearing. Fire rated pivot sets shall have steel top pivots. Fire rated doors require steel intermediate pivots.



introduction

Yale® 4600(LN) cylindrical locks are the ideal choice for a wide variety of commercial applications where consistent quality, ease of use and installation are required at an economical price. The 4600(LN) Series is certified to ANSI/BHMA Grade 2 standards and is UL fire-listed for all functions ensuring reliability and peace of mind.

a.d.a.

The 4600LN series lever designs meets accessibility guidelines of the Americans with Disabilities Act and the requirements of the Uniform Federal Accessibility Standards and ANSI A117.1, all requiring ease of accessibility for the handicapped.

ansi/bhma

Certified ANSI/BHMA A156.2, Series 4000 Grade 2.



backset

The 4600(LN) series cylindrical locksets are available with a 2-3/4" (70mm) standard or 2-3/8" (60mm) optional backset.

door thickness

Adjustable for doors 1-3/8" (35mm) to 1-3/4" (44mm).

installation

Fits ANSI/BHMA A156.115, which covers Hardware Preparation in Steel Doors and Frames and ANSI/BHMA A156.115-W for Wood Doors with Wood or Steel Frames.

latchbolts

2-3/4" (70mm) backset, 1/2" (13mm) throw latchbolt deadlocking or plain supplied standard. See page 6 for optional latchbolts.

through-bolts

4600LN cylindrical lever locks are supplied with optional through-bolts. Installation of through-bolts is at the discretion of the installer.

fire listings

4600(LN) series locksets are UL - cUL listed for use on fire doors having a rating up to and including 3 hours.

strikes

ANSI strike 4-7/8" x 1-1/4" x 1-1/4" (124mm x 32mm x 32mm) lip to center supplied standard for lever. T-Strike 2-3/4" x 1-1/8" x 1-1/4" (70mm x 29mm x 32mm) lip to center supplied standard for knob. See page 7 for optional strikes.

warranty

The 4600(LN) series cylindrical locks carry a three-year mechanical warranty.

windstorm

4600LN Certified
(refer to local codes).



Hurricane

contents

Introduction	2
Trim Designs	3
Functions	4-5
Cylinders/Keying	5-6
Latchbolts	6
Strikes	7
How to Order	7

handing

Locksets are non-handed and easily field reversible.

finishes

ANSI/ BHMA Code	Finish Description
605	Bright Brass, Clear Coated (Lever and Knob)
606*	Satin Brass, Clear Coated (Lever and Knob)
612	Satin Bronze, Clear Coated (Lever and Knob)
613	Dark Oxidized Satin Bronze, Oil Rubbed (Lever and Knob)
625	Bright Chrome Plated (Lever Only)
626*	Satin Chrome Plated (Lever Only)
629	Bright Stainless Steel (Knob Only)
630	Satin Stainless Steel (Knob Only)

*Cylinders provided in these finishes only.

4600(LN) series | grade 2 cylindrical locks

trim designs

levers

Augusta AU

Lever: Cast Zinc
Rose: Wrought Brass

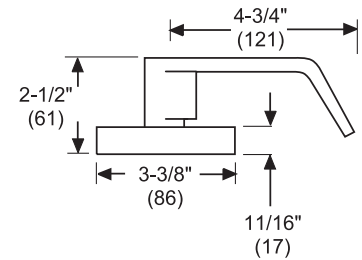

Monroe MO

Lever: Cast Zinc
Rose: Wrought Brass

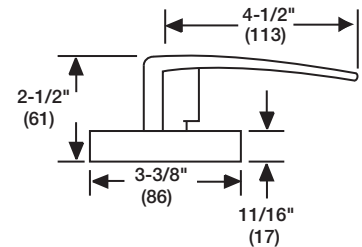

Pacific Beach PB

Lever: Cast Zinc
Rose: Wrought Brass

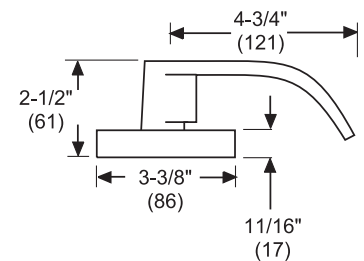

Note: Except for 626 finish, extended lead times apply for Monroe (MO) lever handle. Contact Customer Service for more information.

knob

Carolina CA

Knob: Stainless Steel or Wrought Brass
Rose: Stainless Steel or Wrought Brass

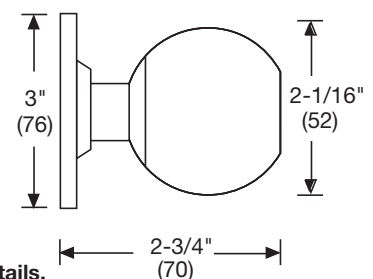

All levers and knob available with small format interchangeable core. See page 5-6 for details.

Dimensions shown are in inches/mm.



functions

4601LN (F75)	4601 (F75)	4602LN (F76B)	4602 (F76B)
Passage or Closet Latch <ul style="list-style-type: none"> For doors that do not require locking. Either lever/knob operates latchbolt at all times. 		Privacy, Bedroom or Bath Lock <ul style="list-style-type: none"> For lavatory or other privacy doors. Either lever/knob operates latchbolt unless outside lever/knob is locked by pushbutton inside. Button automatically releases when inside lever/knob is turned or door is closed. Emergency key inserted and turned in hole in outside lever/knob will unlock door from outside. (Emergency key furnished with lockset.) Inside lever/knob always active. 	
4604LN (F82B)	4605LN (F86)	4605 (F86)	
Entry Lock <ul style="list-style-type: none"> For entrance or office doors. Deadlocking latchbolt. Either lever operates latchbolt (except when outside lever is locked from inside).* Pushing button in inside lever locks outside lever. (Automatically releases when inside lever is turned or key is rotated in locked outside lever.) Latchbolt is operated by key in outside lever or by rotating inside lever. Inside lever always active. 		Storeroom or Closet Lock <ul style="list-style-type: none"> For use on storeroom, utility, exit doors. Deadlocking latchbolt. Latchbolt operated by lever/knob inside, key in outside lever/knob. Outside lever/knob always rigid. Inside lever/knob always active. 	
4607LN (F109)	4607 (F109)	4608LN (F84)	4608 (F84)
Entry Lock <ul style="list-style-type: none"> For entrance, general home or office doors. Deadlocking latchbolt. Either lever/knob operates latchbolt (except when outside lever/knob is locked from inside). Pushing turn button in inside lever/knob locks outside lever. (Automatically releases when inside lever/knob is turned or key is rotated in locked outside lever/knob.) Outside lever/knob may be retained in locked position by pushing and rotating turn button 90° clockwise to a horizontal position; not released until turn button is manually returned to the vertical position. Latchbolt is operated by key in outside lever/knob or by rotating inside lever/knob. Inside lever/knob always active. 		Classroom Lock <ul style="list-style-type: none"> For classroom or utility room doors. Deadlocking latchbolt. Either lever/knob operates latchbolt (except when outside lever is locked by key). Inside lever/knob always active. Key releases outside lever/knob. 	

functions

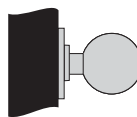
4628LN (F111)	4655LN	4655
		
Communicating Passage Lock <ul style="list-style-type: none"> For twin communicating or exit doors where one side operation is required. Also when space is limited between door and switch panel. Deadlocking latchbolt. One lever operation. Blank rose. Should be used only where rooms have more than one entrance. 	Single Dummy Trim <ul style="list-style-type: none"> For non-operational levers used for decorative trim. Rigid lever/knob. 	

cylinders/keying

Illustration	Type	Model Number	Number of Pins
	Key-in-Knob Cylinder	1805	6
	Key-in-Lever Cylinder	1806	6

Keying:

All cylinders furnished standard 6-pin, keyed random in Yale® PARA keyway, pinned to *Yale* .019" specification. Each cylinder furnished with two nickel silver keys. Optional *Yale* keyways available upon request, extended lead times may apply.

Options:

Cylinders available 0-bitted, keyed alike or master keyed upon request. Construction master keying not available.

levers accepting small format interchangeable cores

	Cylinder Type	Prefix	Ordering Example
	SFIC (Accepts all Small Format Interchangeable Cores) 6- or 7-pin.	B (i.e. B-AU, B-MO, B-PB)	B-PB-4607LN x 626

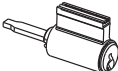
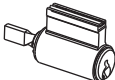
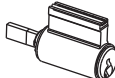

other manufacturers keyway cylinders/cores

Illustration	Type	Model Number	Number of Pins
	Best® Keyway Core. Available keyed random, master keyed or uncombined. Specify keyway A, B, C, D, E, F, G, H, J, K, L or M.	A600	6 or 7 (Specify)
	Schlage® C Keyway Knob Cylinder. Available 0-bitted or keyed random.	2805 x C	6
	Schlage® C Keyway Lever Cylinder. Available 0-bitted or keyed random.	2806 x C	6
	Corbin Russwin L4 Keyway Cylinder. Available keyed random.	3806 x L4	6
	Corbin 60 Keyway Cylinder. Available keyed random.	3806 x 60	6
	Russwin D1 Keyway Cylinder. Available keyed random.	3806 x D1	6
	Sargent® LA Keyway Cylinder. Available keyed random.	3806 x LA	6
	Schlage® E Keyway Cylinder. Available keyed random.	3806 x E	6

Note: 2805, 2806 and 3806 cylinders are supplied with applicable tailpieces that are needed to operate 4600(LN) locksets. These cylinders are not ANSI/BHMA certified.

latchbolts

plain latchbolts

Model No. MCP234 supplied standard with all 4600(LN) series locksets without locking function. Model No. MCP234 latchbolt has a 2-1/4" x 1-1/8" front with a 2-3/4" backset and a 1/2" bolt throw. Optional latchbolts available to special order.

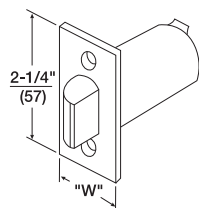

Model Number	Front	Backset	Throw	"W" Front Width	Latch Diameter*
MCP238	Square	2-3/8" (60mm)	1/2" (13mm)	1" (25mm)	7/8" (22mm)
MCP238R	Round	2-3/8" (60mm)	1/2" (13mm)	1" (25mm)	7/8" (22mm)
MCP234	Square	2-3/4" (70mm)	1/2" (13mm)	1-1/8" (29mm)	7/8" (22mm)

*1/8" sleeve (P/N 14-0378-9001) supplied with all latchbolts to accommodate 1" preps.

deadlocking latchbolts

Model No. MCD234 supplied standard with all 4600(LN) series locksets with locking function. Model No. MCD234 latchbolt has a 2-1/4" x 1-1/8" front with a 2-3/4" backset and a 1/2" bolt throw. Optional latchbolts available to special order.

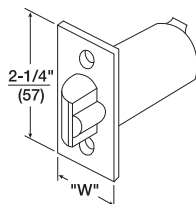

Model Number	Front	Backset	Throw	"W" Front Width	Latch Diameter*
MCD238	Square	2-3/8" (60mm)	1/2" (13mm)	1" (25mm)	7/8" (22mm)
MCD238R	Round	2-3/8" (60mm)	1/2" (13mm)	1" (25mm)	7/8" (22mm)
MCD234	Square	2-3/4" (70mm)	1/2" (13mm)	1-1/8" (29mm)	7/8" (22mm)

*1/8" sleeve (P/N 14-0378-9001) supplied with all latchbolts to accommodate 1" preps.

strikes

Yale® 4600(LN) locks are available with a variety of strike options. All strikes are located on the same vertical and horizontal center lines as the latchbolt. Some strikes are available in a variety of lip lengths to accommodate varying thickness of doors and frames. To determine the proper length of the lip, measure from the center line of the strike to the edge of the jamb, accounting for any interfering trim (i.e. wood molding) and then add 1/4" (6mm) for curved lip. All strikes are reversible. Strikes are fabricated of either brass, bronze or stainless steel, depending on the lockset trim finish. When ordering strikes separately, specify the finish required.

<p>Model No. 371 T-Strike (Standard for Knob - Optional for Lever) 2-3/4" x 1-1/8" x 1-1/4" (70mm x 29mm x 32mm) lip to center supplied standard for knob. 1", 1-1/2", 1-3/4" and 2" curved lip lengths available by special order. Wrought strike box supplied.</p>	<p>Model No. 497 ANSI Strike (Standard for Lever - Optional for Knob) For door and frames with ANSI/BHMA A156.115 preparations. 4-7/8" x 1-1/4" x 1-1/4" (124mm x 32mm x 32mm) lip to center supplied standard for lever. Optional lip lengths are not available. Available with optional 202 Strike Box. Specify 497 x 202.</p>	<p>Model No. 70S Full Lip Strike (Optional for Knob or Lever) 2-1/4" x 1-3/4" x 1-1/4" (57mm x 44mm x 32mm) lip to center with full lip anti-rattle tab. Wrought strike box supplied.</p>	<p>Model No. 71S Full Lip Strike (Optional for Knob or Lever) 1/4" radius. Similar in dimensions and function to the 70S Strike but with radius corners for easy mortising by power tools. Anti-rattle tab. Wrought strike box supplied.</p>	<p>Model No. 202 Strike Box Available to special order. Specify 497 x 202.</p>
---	---	--	---	---

attaching screws

For Model Nos. 371, 70S, and 71S

#8-32 x 3/4" (19mm) Phillips flat head combination wood and machine screws.

For Model No. 497

#12-24 x 1" Phillips flat head combination wood and machine screws.

how to order

Design	Function	Hand	Latch	Strike	Cylinder	Door Thickness	Keying	Finish
See page 3	See pages 4-5	Specify	See page 6	See page 7	See page 5-6	See page 2	See page 5	See page 2

ordering example

Design	Function	Hand	Latch	Strike	Cylinder	Door Thickness	Keying	Finish
AU	4607LN	RH	MCD234	497	1806	1-3/4"	KR	626



nexTouch™

Keypad Locks



An ASSA ABLOY Group brand

ASSA ABLOY



nexTouch™ Cylindrical



Hurricane





Features & Benefits

Feature	Benefit	Stand-alone	Data-on-Card*	Zigbee/Z-Wave
Choice of capacitive touchscreen or tactile pushbutton keypad	Touchscreen responds to human touch, enabling convenient entrance or access to programming menu. Pushbutton keypad option also available for more tactile requirements, such as ADA compliance.	✓	✓	✓
Keyless entry and management	Reduces complexity of key system management	✓	✓	✓
PIN code access	Installations are able to be programmed with up to 500 unique PIN codes and a master codes for access to programming.	✓	✓	✓
Modular technology	Allows for upgrade to more advanced security technologies with Data-on-Card and ZigBee/Z-Wave capabilities as requirements change and grow.	✓	✓	✓
Works with cloud-based management software	Single system enables use from anywhere with Internet access from a range of devices, including your computer, smartphone or tablet.		✓	✓
Audit trail	Lifetime audit trail stored within the software to know exactly who has accessed the lock when.		✓	✓
Voice-guided programming in 3 languages	Voice-guided prompts make updates straightforward and effortless in English, Spanish or French.	✓	✓	✓
Three (3) volume modes	Playback can be set for normal, low or silent.	✓	✓	✓
Privacy feature with Door Position Switch	By holding the interior lock button down for 1.5 seconds, the exterior keypad is temporarily disabled ensuring complete privacy and no additional entry.	✓	✓	✓
Weather resistant gasket seal	Lock is operational even in outdoor settings, in temperatures ranging from -40°F to 140°F (-40°C to 60°C) at 95% relative humidity.	✓	✓	✓
Low battery indicator	Blinking designation signals internal 4 AA alkaline batteries are low.	✓	✓	✓
9V battery power backup feature	With the touch of a 9V battery to the designated area on the front of the lock, your nexTouch can be powered up for one-time entry.	✓	✓	✓
Optional passage mode	PIN codes can be used to enable passage mode, allowing for continuous entry for non-restricted traffic.	✓		✓
Hardwire power capable	Can be powered externally using remote 9VDC power supply and plug-in wall transformer.	✓	✓	✓
Keypad lockout feature	Deters tampering by disabling the keypad for a default of 180 seconds after five (5) successive failed attempts.	✓	✓	✓

*Data-on-Card technology module available only through Authorized Channel Partners. Please contact your ASSA ABLOY Door Security Solutions sales consultant for more information.

Dimensions

CYLINDRICAL

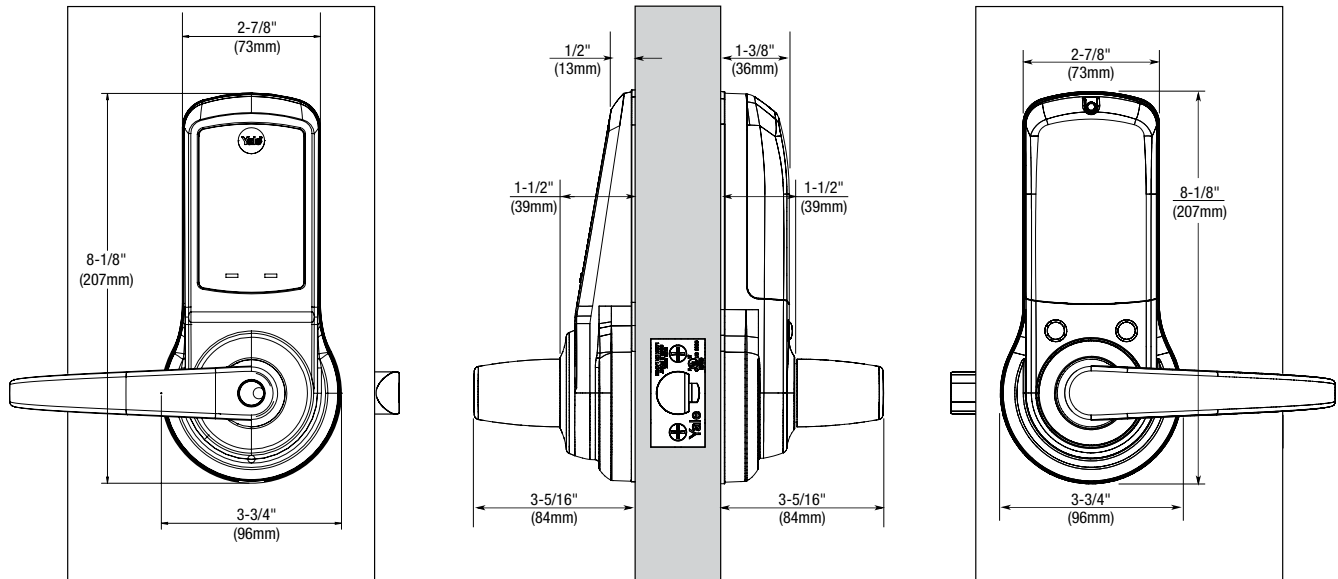

Dimensions given in inches (mm).



Certifications and Listings

CYLINDRICAL & MORTISE

ADA



The nexTouch Series lever design meets accessibility guidelines of the Americans with Disabilities Act and the requirements of the Uniform Federal Accessibility Standards and ICC/ANSI A117.1 Accessible and Usable Buildings and Facilities, all requiring ease of accessibility.

ANSI/BHMA

nexTouch cylindrical certified ANSI/BHMA A156.2, Series 4000 Grade 1.



nexTouch mortise certified ANSI/BHMA A156.13, Series 1000 Grade 1.

FIRE LISTINGS



Functions are UL/cUL Fire Listed for use on fire doors having a rating up to and including 3 hours.

Note: Any retrofit or other field modification to a fire rated opening can potentially impact the fire rating of the opening, and Yale Locks & Hardware makes no representations or warranties concerning what such impact may be in any specific situation. When retrofitting any portion of an existing fire rated opening, or specifying and installing a new fire-rated opening, please consult with a code specialist or local code official (Authority Having Jurisdiction) to ensure compliance with all applicable codes and ratings.

FCC

Complies with limits for a Class B digital device, pursuant to part 15 of the FCC Rules.

ISO 14001

Designed and manufactured under a certified ISO 14001 quality system.

SUSTAINABILITY

EPD and GreenCircle certification.

WARRANTY

nexTouch has a three year limited warranty on the mechanical and electrical components, and a one year limited warranty on the finish.

WINDSTORM

Certified (refer to local codes).



Hurricane

Dimensions and Lever Designs

DIMENSIONS

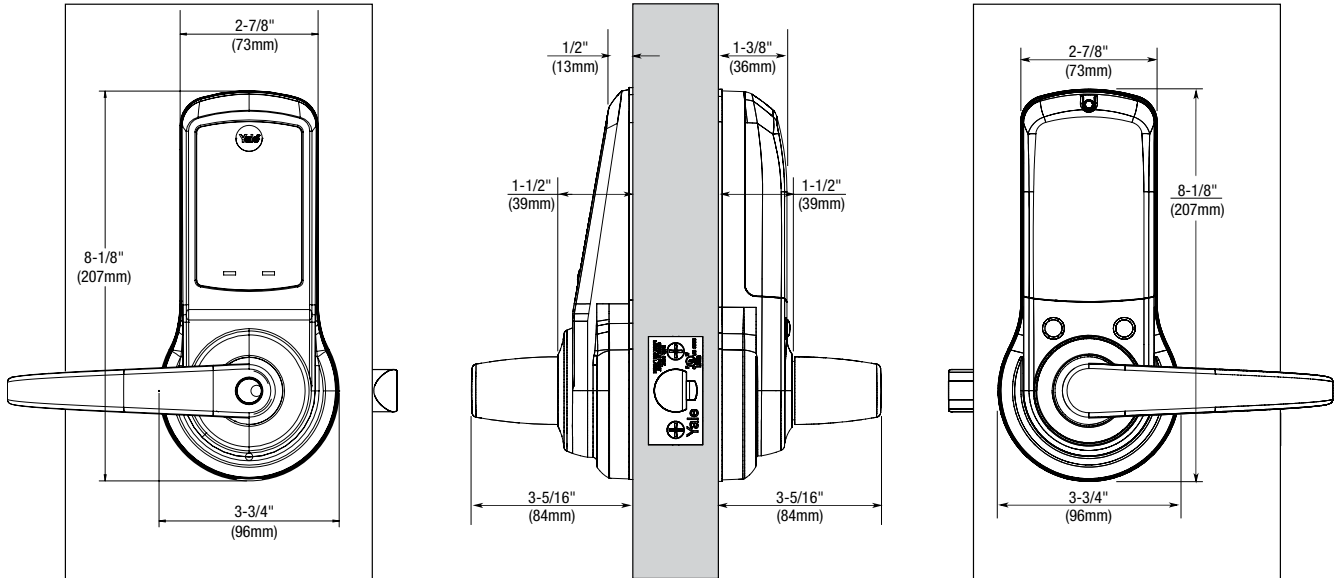

Dimensions given in inches (mm).

LEVER DESIGNS

AUGUSTA AU Lever: Cast Zinc

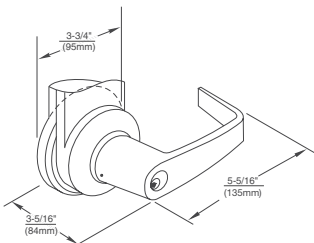

MONROE MO Lever: Cast Zinc

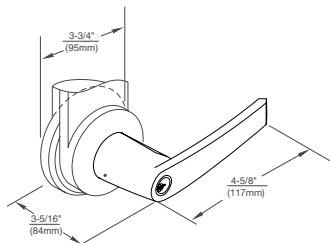

PACIFIC BEACH PB Lever: Cast Zinc

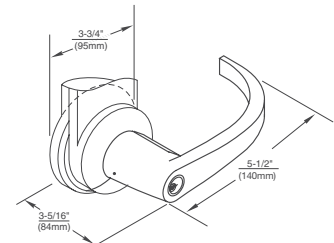

 All levers available with small and large format interchangeable core. See page 11 for details.



Functions, Technology Options and Finishes

FUNCTIONS

NTB630 Pushbutton NTB640 Touchscreen

Without Cylinder Override

- For doors that do not require mechanical key override.
- Latchbolt retracted by lever outside with valid PIN code, or by operating lever inside.
- Inside lever always active.
- Deadlocking latchbolt.

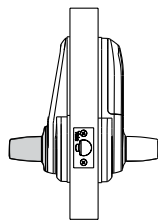

Outside

Inside

NTB610 Pushbutton NTB620 Touchscreen

With Cylinder Override

- For doors that require mechanical key override.
- Latchbolt retracted by lever outside with valid PIN code; by use of mechanical key, or by operating lever inside.
- Inside lever always active.
- Deadlocking latchbolt.

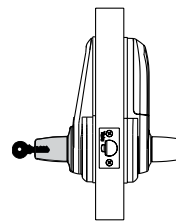

Outside

Inside

Lever handles are Free Wheeling in locked position. Shaded area denotes Free Wheeling lever.

TECHNOLOGY OPTIONS

NR	Keypad only, no radio
HA2	ZigBee wireless communication
ZW2	Z-Wave wireless communication

Data-on-Card Yale Accentra™ module available only through Authorized Channel Partners. Please contact your Door Security Solutions sales consultant for more information.



ZigBee Module



Z-Wave Module

FINISHES

ANSI/BHMA Code Finish Description

605
Bright Brass, Clear Coated



613E
Dark Oxidized Satin Bronze -
equivalent



626
Satin Chrome Plated



676
Flat Black Powder Coat



Concealed Mount – Interior – Medium Traffic Doors

Product Description & Features

- Doors may be single or double acting
- Non-handed
- Slide track design
- Recommended for medium traffic, medium weight doors
- Degree of opening is fully adjustable and can be adapted to changing needs
- Heavy shock absorber spring provides 5 -7° compression before dead stop
- Can be ordered specifically as a stop, friction stay, or hold open
- Multi-function unit is shipped as a stop. Can be converted to a hold open or friction in the field. 5012-PKG (*Adapter kit*) included
- Complete screw packet kit for installation in wood or metal door and frame
- For security areas, Torx® screws available for exposed fasteners, but heavy-duty units should be considered for high security applications
- Standard architectural finishes
- Durable slider cam and shock block
- 110° maximum opening
- 3/4" square channel
- Stop function UL listed for fire door assemblies
- Hanging means other than standard butts or offset pivots require special templating and pricing. Consult factory

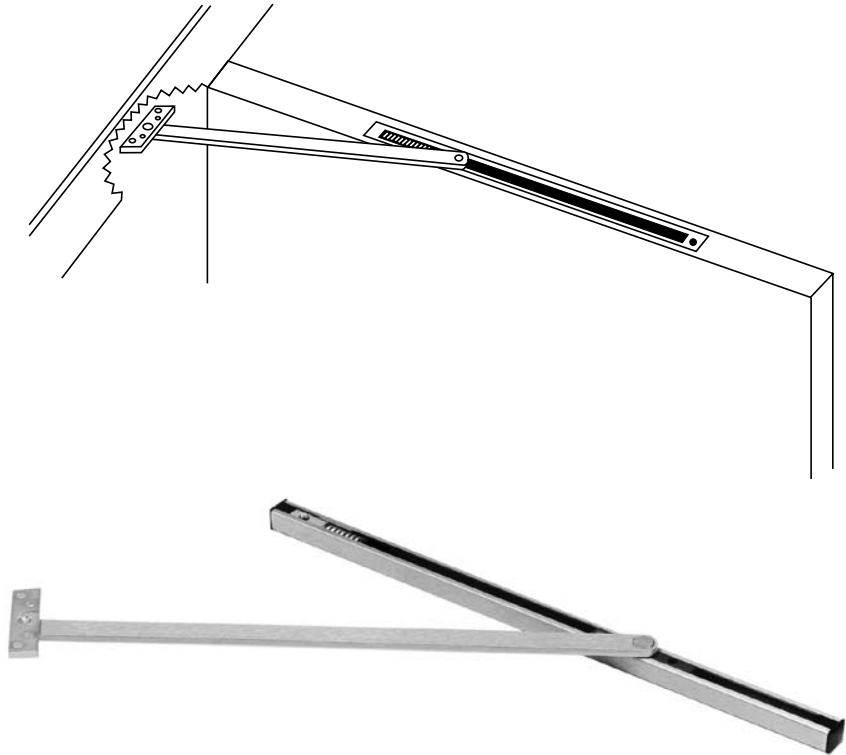

Door Opening Chart (*in inches*)

Butts Offset Pivots	Center Hung Pivots	Model Number			
		Friction	H.O.	Stop	Multi
*18 - 24	—	2-116	2-126	2-136	2-146
24-1/16 - 30	27 - 32	2-216	2-226	2-236	2-246
30-1/16 - 36	32-1/16 - 38-1/2	2-316	2-326	2-336	2-346
36-1/16 - 42	38-9/16 - 45	2-416	2-426	2-436	2-446
42-1/16 - 48	45-1/16 - 48	2-516	2-526	2-536	2-546

*Butt hung only on this size door. No swing clear hinges.

ANSI No.			
Shipping Weight 3.5 lbs.	Friction	H.O.	Stop
	C04532	C04512	C04542

Options

Less Spring – Suffix LS

Heavy duty slide track type stops have a spring in the end of the channel that keeps the slider from deadstopping. If these units are being used with electromechanical closer, where the door must deadstop, the LS option is needed. For non-adjustable models 1 and 9 only.

Angle Jamb Bracket Adapter – Standard-duty models suffix 5258 (non-handed) Heavy-duty models suffix 5458 (LH) or 5459 (RH)

When surface mounted units are mounted on a rabbeted door on the push side, flush door and transom on the push side, or in a reverse installation on the pull side of the door a special bracket is needed. Note that not all models can be mounted on the pull side of the door (*See specific model numbers in catalog.*)

Security Screws – Suffix Torx

Security screws can be supplied for exposed fasteners.



5258



5458

Certifications

All Rixson Checkmate® overhead stops and holders are in compliance with ANSI/BHMA 156.8, Grade 1 and 2 Standards. See individual products for sub sections. See individual models for UL Listing.



Limited Warranty

Rixson Checkmate® stops and holders are warranted for 2 years for defect. See *Rixson* price book for specific details of the limited warranty

Specifications

All overhead stops and holders shall be from a single manufacturer.

Standard-duty models used for interior or low to medium traffic doors.

Heavy-duty models used for exterior or high traffic doors or doors subject to abuse.

For extremely abusive areas or high winds use double lever arm type.

Coordinate deadstop and/or hold open location with concealed floor closers.

Checkmate products provide hold open and/or deadstop.

8000 SERIES

Architectural Door Closer



Norton®
ASSA ABLOY



ASSA ABLOY, the global leader
in door opening solutions

OVERVIEW

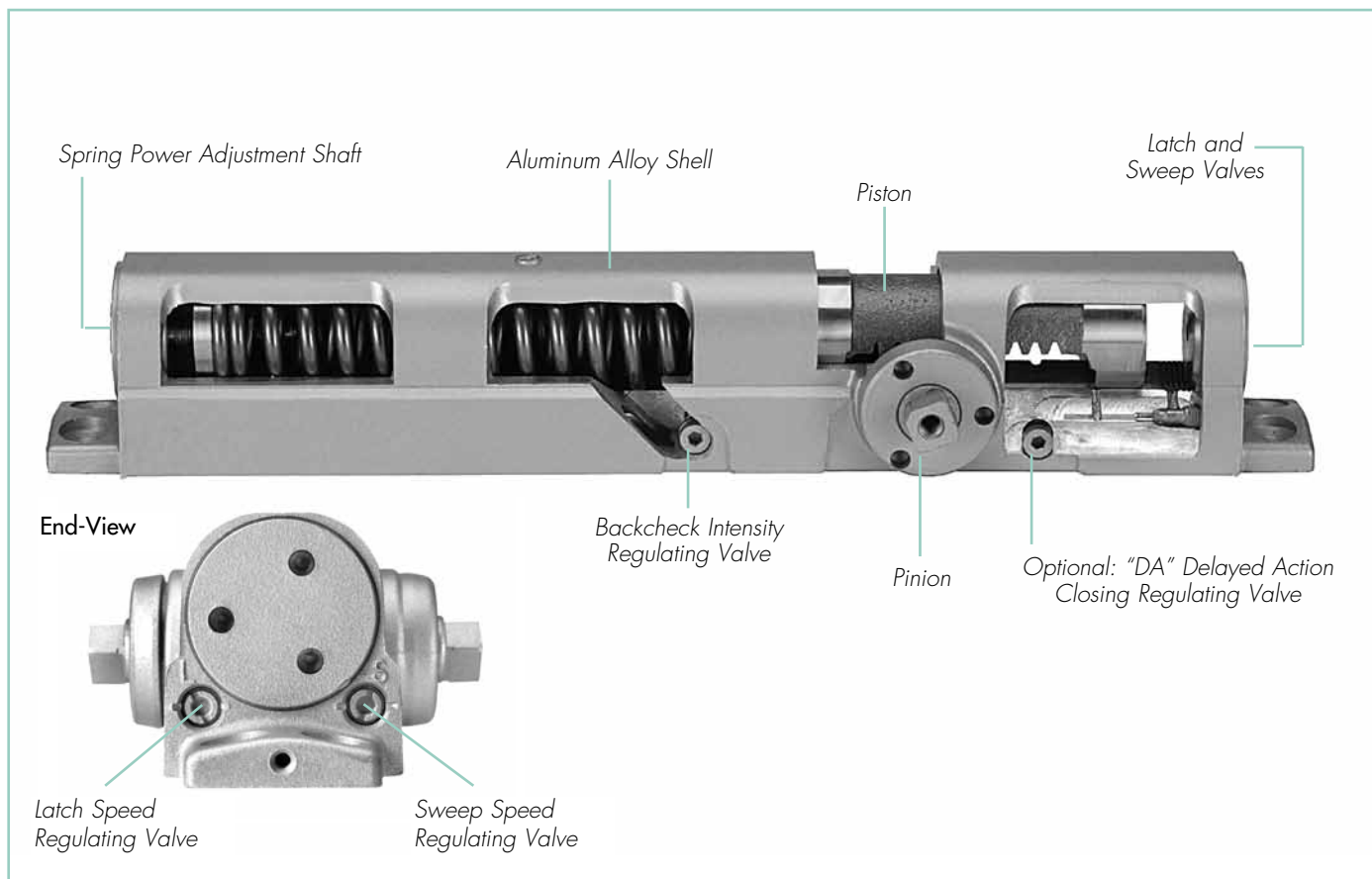
Cutaway View



COMPLIANCE STANDARDS

- ANSI/BHMA A156.4, Grade 1 certified 
- UL / cUL listed for use on fire rated doors 
- UL10C listed for positive pressure fire test
- 8301 and 8501 door closers are designed to comply with requirements for the Americans with Disabilities Act (A.D.A) and ANSI standard A117.1 
- This product is manufactured in an ISO 9001 facility

CAUTION: Door Closers for Low Opening Force Applications:

Door closers installed in openings required to meet the requirements of The Americans with Disabilities Act or ANSI/BHMA Standard A117.1, when adjusted to meet those requirements, may not provide adequate closing power to dependably close and latch the door.

HOW TO ORDER

For optimum protection of door and frame assemblies, always use auxiliary wall, floor, or overhead door stop.

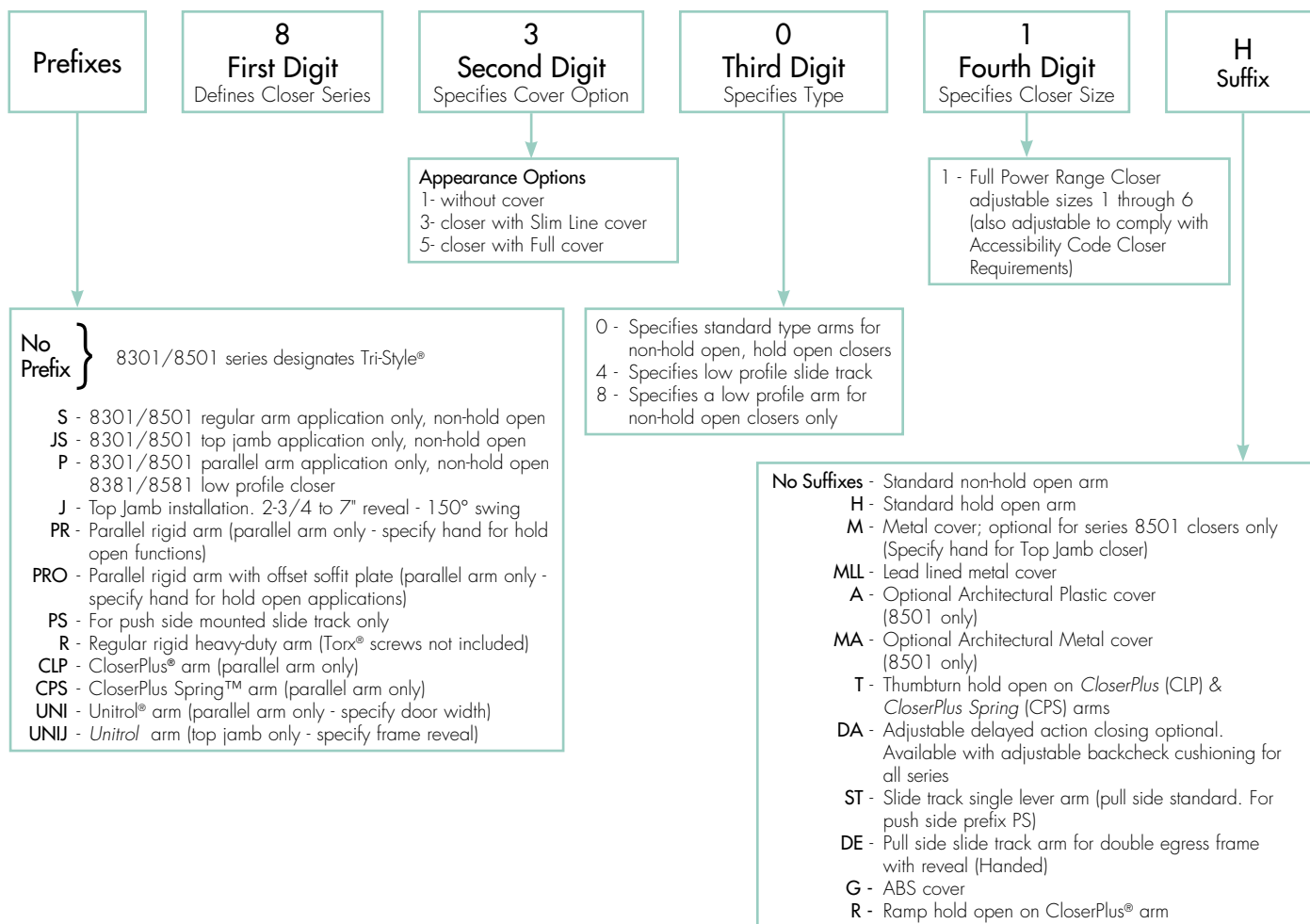

Notes:

- Warranty becomes void if door closer is installed on the exterior side of a door in the exterior wall of a building.
- It is strongly recommended, and required on fire door assemblies, that doors having a door closer be hung on ball bearing or anti-friction hinges or pivots; unless an alternate method is identified in the door manufacturer's listing.
- Failure to use the correct type and size fasteners may void factory warranty.
- Fasteners for fire/smoke door assemblies must conform to NFPA 80. In some applications additional fasteners may be mandated by NFPA 80 that are not shipped with standard Norton product, such as sleeve-nuts/sex nuts or through-bolts and grommet nuts.
- Sizing charts provided on pages 13-25 are based on 1-3/4" (44mm) x 7" (2.13m) standard weight doors swinging to 110°. Other conditions (such as door height or weight; or wind/draft conditions) may require a larger size closer.

FASTENERS

Type	Description	Arm								
		RA	PA	TJ	Low Profile	PR	CLP / CPS	UNI	UNI-J	Slide Track
DOOR										
SDST	Self Drilling Self Tapping	S	S	S	S	S	S	S	O	O
MS	Machine Screw	S	S	S	S	S	S	S	S	S
SN	Sleeve Nut/Sex Nut	O	O	O	O	S	S	S	S	S
TBGN	Through-Bolts & Grommet Nuts	O	O	O	O	O	O	O	O	O
SMS	Sheet Metal Screws	O	O	O	O	O	O	O	O	O
Torx®	Torx Drive Security Screw	O	O	O	O	O	O	O	O	O
FRAME										
SDST	Self Drilling Self Tapping	S	S	S	S	S	S	S	S	S
MS	Machine Screw	S	S	S	S	S	S	S	S	S
SMS	Sheet Metal Screws	O	O	O	O	O	O	O	O	O
Torx	Torx Drive Security Screw	O	O	O	O	O	O	O	O	O

S = standard; O = optional

SN are for use on unreinforced hollow metal doors or to prevent any hollow metal door from collapse/dimpling. They can also be used for thru bolting on wood doors. SN are supplied for 1-3/4" (44mm) thick doors unless specified for 2-1/4" (57mm) thick doors.

TBGN are an alternative to SN for wood doors. TBGN are supplied standard for 1-3/4" (44mm) thick doors. They can be specified for 1-3/8" (35mm) thick doors.

SMS - when specified, closer will be packed with sheet metal screws for the door AND sheet metal screws plus machine screws for the frame.

TORX screws with security pin are standard with Security Door Closers. Torx may be specified for all other series applications. Torx are only available with machine screw threads. Sheet metal screw threads or wood screw threads are not available.

Note: To order special fasteners with closers, specify model number x fastener (Ex: 8501 x 689 x TBGN)

FINISHES

Norton offers waterborne acrylic, polyester powder coat and plated finishes. Custom finishes are available on special order. A sample and approval is required.

Waterborne acrylic and polyester powder coat will withstand 100 hours of salt spray (ANSI requires 25 hours).

ANSI/BHMA	Description
600*	Prime Coat
605	Bright Brass
606	Satin Brass
611	Bright Bronze
612	Satin Bronze
613E	Dark Oxidized Satin Bronze - Equivalent
619	Satin Nickel
625	Bright Chrome
626	Satin Chrome

ANSI/BHMA	Description
689	Aluminum
690	Statuary Bronze
691	Dull Bronze
693	Black
694	Medium Amber
696	Gold
N/A	556 White

* 600 is a special rust-inhibiting prime coat. Closers can be ordered prime coat only (specify closer x 600). An additional charge applies if finish coat is required over prime coat.

- Norton closer bodies and plastic covers are available in waterborne acrylic finishes. Arms and metal covers are available in powder coat or plated finishes.
- When a plated finish is ordered, arm and cover will be plated unless "cover only" is specified.

FEATURES

Aluminum Alloy Housing

Closer bodies are constructed of a special aluminum alloy, carefully selected to accommodate interactive steel components and operating conditions.

Rack & Pinion Operation

Provides a smooth constant control of the door through its full opening and closing cycle. 180° door swing can be achieved when door, frame, hardware and arm function do not interfere.

Non-handed

With few exceptions all series 8301/8501 door closers are non-handed and can be installed on either right- or left-hand swing doors. Pinion shaft extends vertically through the closer body in both directions. Some options, as noted on pages 6-7, will require that the hand of the closer be specified.

Sweep Speed Control Valve

Allows adjustment of door speed from the door's full open position down to approximately 10° from the closed position.

Latch Speed Control Valve

Allows adjustment of door speed from approximately 10° down to the door's fully closed position.

Tri-Style®

8301/8501 comes with screws, brackets and soffit plates to allow for regular, top jamb, and parallel arm installations.

Adjustable Backcheck Valve

Provides control of the door in the opening cycle, beginning at approximately 75° of door opening. It cushions the door opening when the door is forcibly opened beyond its pre-adjusted limits.

Standard Molded Covers

Molded of high-impact U.L. listed material. These covers are non-handed for all applications.

Warranty

Limited 25-year warranty for defects and life of the building on the aluminum housing.

Closer Fluid

NorGlide® closer fluid is a specially formulated multi-viscosity hydraulic fluid that contains lubricity and anti-oxidation agents that provide optimum performance and efficiency. This fluid complements the interaction of the door closer's aluminum housing with its steel and brass components, while maintaining stable viscosity to allow the door closer to perform in temperatures ranging from extremely high to as low as -40° F.

Door Closer Power Options

Series 8301/8501 Multi-Sized Door Closer

Adjustable through the power range of sizes 1 through 6; as outlined in ANSI/BHMA specification A156.4 option PT 4H.

Closers will also comply with the opening force requirements as outlined in the Americans with Disabilities Act (ADA) and ANSI/BHMA standard A117.1 for interior doors.

OPTIONAL FEATURES COVERS

Optional Metal Cover

This steel cover is non-handed for regular and parallel arm applications, but is handed for top jamb applications. Cover is available in sprayed or plated finishes.



Optional Architectural Covers *

Plastic

Architectural plastic covers are molded of high-impact U.L. listed material. They are non-handed and available in sprayed finishes.

Metal

The architectural metal covers are steel and non-handed for all applications. These covers are available in sprayed or plated finishes.



Optional ABS Cover

Consult factory for details

OPTIONAL FEATURES

Adjustable Delayed Action Closing

An optional hydraulic feature that adds a third speed range to the closing cycle. This feature becomes effective when the door is opened and released at any point beyond 70°. The amount of time delay depends upon the combination of the angle of door release and valve adjustment. The valve can be adjusted with a 1/8" (3mm) hex key from no delay time up to maximum delay times of:

Door Opened	Approximate Time of Delay Cycle
180°	4-5 minutes
120°	2-3 minutes
90°	25-30 seconds

Pressure Relief Safety Valve

The delayed action hydraulic system contains a pressure relief valve. Any time the door is forced toward the closed direction while it is in the closing cycle, the valve will open and permit the door to close. This prevents damage to door, frame and closer.

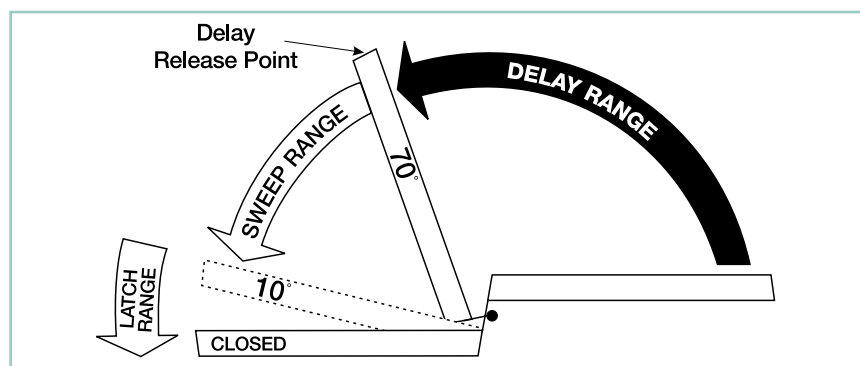

Suggested Applications

Delayed Action closing allows slow-moving traffic to clear the opening before the door closer's normal closing cycle begins. This feature can be helpful in health care facilities such as hospitals and nursing homes. It provides sufficient time for persons on crutches or in wheelchairs to pass through a door without concern of it closing. At the same time, it can accommodate the facility's staff with movement of food service carts, beds, and other wheeled traffic.

Use of delayed action closers on many doors throughout industrial and commercial buildings can also assist the flow of traffic. Locations where additional time to clear the opening is advantageous are doors between office and factory/warehouse facilities, doors to workshops or laboratories, to kitchen and food processing areas, etc.

OPTIONAL FEATURES ARMS

Non-Hold Open

Self-closes door every time door is opened. Auxiliary stop (by others) required except when using the CloserPlus®, CloserPlus Spring™ or Unitrol® arms.

Hold Open

Achieved by means of friction or ball and detent/ roller. Friction hold open has a range of 90° to 180° using template location and mechanical adjustment.

Ball and detent or roller hold open is effective in a range of 85° to 110°.

Hold open arm door closers are not permitted to be used on fire door assemblies.

Door Opening Degrees

Arm Function	Regular Arm, Top Jamb Parallel Arm	Parallel Rigid Arm	CloserPlus® Parallel Arm	CloserPlus Spring™ Parallel Arm	Unitrol® Parallel Arm	Unitrol Top Jamb	Low Profile Regular, Parallel	Slide Track
Non-Hold Open	✓	✓	85° to 110°	85° to 110°	85° to 110°	85° to 110°	✓	85° to 110°/180°
Hold Open	90° to 180°	85° to 180°	85° to 110°	85° to 110°	85° to 110°	85° to 110°	N/A	85° to 110°

✓=180° trim and template permitting

APPLICATIONS

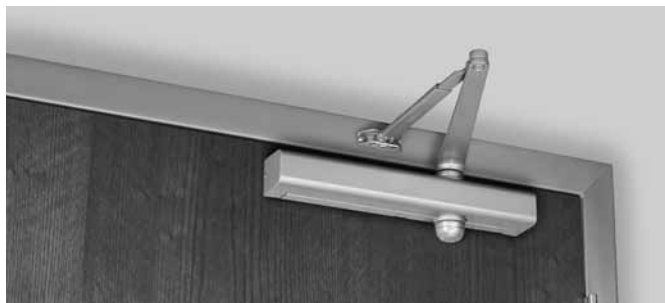

Regular Arm

8301 - slim cover

This is the only pull-side application where a double lever arm is used. It is the most power-efficient application for a door closer. Sufficient frame, door and/or ceiling clearance must be considered.



8501 - full cover

Since the arm assembly projects directly out from the frame, this application may present an aesthetics issue or be prone to vandalism.



Top Jamb

For efficiency reasons this application provides the best alternative to the regular arm application. There must be sufficient frame face and/or ceiling clearance for this application. It requires a top rail on the door of just 2-1/4" (57mm). This application provides the best door control for doors in exterior walls that swing out of a building.



Parallel Arm

This application provides the most appealing design appearance for a surface-mounted door closer having a double lever arm. This also makes it beneficial in vandalism-prone areas. It is on the push side of the door and the arm assembly extends almost parallel to the door. In the closed position, there is very little or no hardware projecting beyond the frame face in most situations.



Due to the geometry of the arm it is approximately 25% less power efficient than a regular arm application. The entire closer and arm assembly are mounted below the frame stop. Top rail clearance dimensions will vary based on the type of cover used. (See pg. 15)

APPLICATIONS



Non-hold open arm shown

Parallel Rigid Arm

An enhanced variation of the standard parallel arm assembly that is intended for use in heavy traffic areas where auxiliary door stops are installed.

Hold open available - specify hand when ordering.



Non-hold open arm shown

CloserPlus® Arm

Similar to the Parallel Rigid arm, this arm incorporates a stop at the arm's soffit plate to dead stop the door at a predetermined degree of door swing between 85° and 110°, in 5° increments. Prior to dead stop the door closer's backcheck feature slows the door speed to reduce the impact of the stop action.

The *CloserPlus* Arm is intended for use where an auxiliary door stop cannot be utilized and no more than moderate abuse is anticipated. Where more extreme conditions are expected, use of a *Unitrol* arm is recommended.

Available with or without hold open. (Hold open strength is adjustable.)



Non-hold open arm shown

CloserPlus Spring™ Arm

This arm has all the characteristics of the *CloserPlus* arm with an additional steel buffer spring that provides greater protection at the end of the door opening cycle.

For extreme conditions, use of a *Unitrol* arm is recommended. Available with or without hold open.



CloserPlus Ramp™

The CLPR uses a patent pending ramp and plunger design that easily slides into place reducing wear often seen on traditional hold open arms. Ideal for applications where the door will constantly be pulled out of hold open.

APPLICATIONS



Regular Rigid Arm

This double lever arm features a non-adjustable secondary arm. Orbitally riveted joints prevent tampering or disassembly. Prefix "R" to model number. Available non-hold open only.



Parallel Rigid Offset Arm

This heavy-duty parallel rigid arm provides additional vertical clearance. It is well suited for applications where weatherstripping or other hardware prevents the use of the standard Parallel Rigid (PR) soffit plate. The non-hold open and hold arms allow 1-1/4" clearance. When used in conjunction with a #6891 spacer block, the PRO arm provides 1-7/8" clearance to accommodate the use of a surface overhead stop/holder.



Parallel

Unitrol® Arm

Can be used for either parallel arm or top jamb applications. *Unitrol* arms combine the features of a double lever arm overhead door stop/holder with the backcheck feature of the door closer to reduce door stopping shock loads to a minimum. The *Unitrol* uses a compression spring buffer at the soffit plate/arm shoe that will absorb 30 lbf. of force, 5° prior to the door's dead stop. Coupled



Top Jamb

with the door closer's backcheck feature, this arm provides the most controlled stop available with a surface door closer. For parallel arm applications there are three different length arm assemblies. Each length is designed for a specific range of door widths, to provide precise door control. This further lessens the dead stop impact on the door's hinges/pivots.

APPLICATIONS



Pull Side



Low Profile Pull Side



Push Side



Low Profile Push Side

Slide Track

Whether pull- or push-side mounted, slide track provides the designer with the smoothest lines available in a surface-mounted door closer. The single lever arm allows components to be located in a stack configuration to minimize projection and eliminate obtrusive arm angles. The arm geometry reduces door closer power efficiency by approximately 25% from that of a regular arm.

Standard unit:

- Adjustable 85°- 110° (hold open and non-hold open). Track is supplied with a spring buffered stop. An auxiliary stop, by others, is recommended.
- Specify if hold open unit is required.
- 180° swing (non-hold open, pull side only) is also available. This track assembly requires that a door stop, by others, be supplied to stop the door.



Regular Arm



Parallel Arm

Regular Arm: Allows closer to be installed where there is as little as 1" (25mm) of frame face or ceiling clearance.

Parallel Arm: Allows closer to be installed 1/2" (13mm) higher up on door than standard parallel arm application.

Low Profile Arm

Supplied with 8381/8581 series door closers for non-hold open installations only. Low profile arms have a reduced height elbow joint and a straight main arm. This enables the door closer to be installed in less vertical space.

Note: Low profile arm door closers are not supplied with Tri-Style® packaging.

REGULAR ARM

Closer Mounting Plates Slim Line Installations

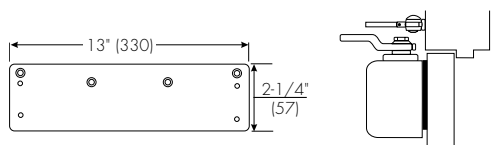

Narrow Top Rail - #8146 Drop Plate: For use where the narrow top rail of the door prevents the closer from being mounted directly on to the door surface. This drop plate must be used for any Series 8000 closer mounted on a top rail between 1-9/16" and 2-7/16" (40 and 62mm) in height, or any Series 8080 closer mounted on a top rail between 1-7/16" and 2-5/16" (36 and 59mm) in height.

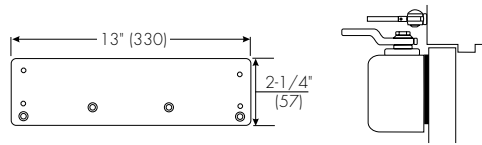

Concealed Door Holder - #8146 Drop Plate: For use where a concealed door holder prevents normal mounting of the closer to the door. This is the same plate used for narrow rail mounting, but is inverted for this application to permit the mounting screws to clear the bottom of the door-holder preparation in the top rail of the door. This places the centerline of the plate's upper mounting screws at 2-3/16" (56mm) from the top of the door.

Full Cover Installations

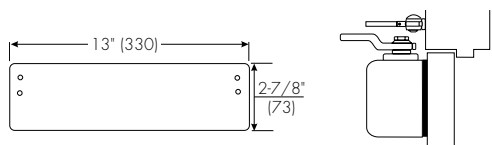

Exposed Back - #8445 Molded Full Cover Decorative Back Plate: For use on doors with glass lights where a closer with a molded full cover is installed and the closer back is exposed. This plate covers the back of the installation to give a pleasing appearance from the reverse side.

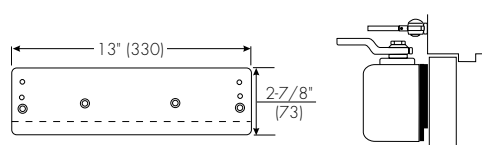

Exposed Back/Narrow Top Rail - Exposed Back Concealed Door Holder - #8446 Molded Full Cover Drop Plate Kit: For use with molded full cover installation when an 8146 Plate is needed as a drop plate on a narrow top rail, or as a clearance plate for a concealed door holder, and the closer back is exposed. Kit contains an 8146 Drop Plate and an 8445 Decorative Plate.

Metal Cover Installations

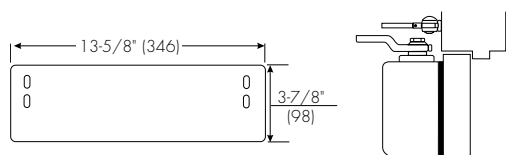

Exposed Back - #8545 Metal Cover Decorative Back Plate: For use on doors with glass lights where a closer with a metal full cover is installed and the closer back is exposed. This plate covers the back of the installation to give a pleasing appearance from the reverse side.

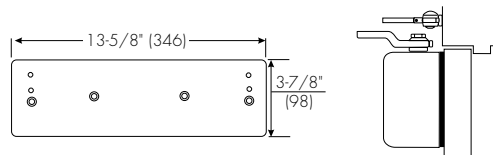

Concealed Door Holder - #8546 Metal Cover Drop Plate: For use where a concealed door holder prevents the normal mounting of the closer to the door. This plate permits the mounting screws to clear the bottom of the door-holder preparation in the top rail of the door. This places the centerline of the plate's upper mounting screws at 2-3/16" (56mm) from the top of the door.

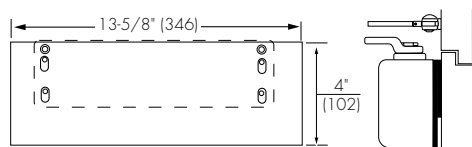

Exposed Back/Narrow Top Rail - #8549 Metal Cover Drop Plate Kit: For use with metal full cover installations, when an 8146 Plate is needed as a drop plate on a narrow top rail and the closer back is exposed. Kit contains an 8146 Drop Plate and an 8545 Decorative Plate.

REGULAR ARM

Closer Mounting Plates
Architectural Plastic or Metal Cover Installations

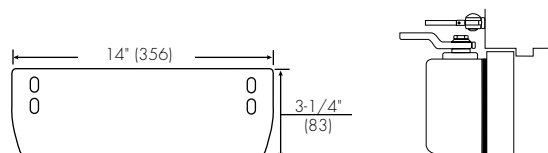

Exposed Back - #8545A Architectural Plastic or Architectural Metal Cover Decorative Back Plate: For use on doors with glass lights where a closer with an architectural plastic or metal cover is installed and the closer back is exposed. This plate covers the back of the installation to give a pleasing appearance from the reverse side.

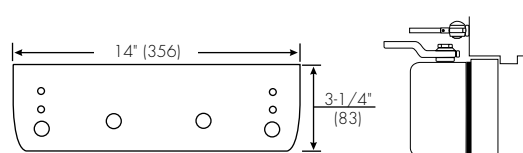

Concealed Door Holder - #8546A Architectural Plastic or Architectural Metal Cover Drop Plate: For use where a concealed door holder prevents the normal mounting of the closer to the door. This plate permits the mounting screws to clear the bottom of door-holder preparation in the top rail of the door. This places the centerline of the plate's upper mounting screws at 2-3/16" (56mm) from the top of the door.

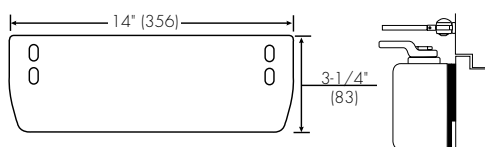

Exposed Back/Narrow Top Rail - #8549A Architectural Plastic or Architectural Metal Cover Drop Plate Kit: For use with architectural plastic or metal cover installations when an 8146 plate is needed as a drop plate on a narrow top rail and the closer back is exposed. Kit contains an 8146 Drop Plate and an 8545A Decorative Plate.

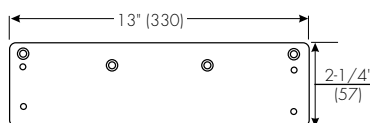

REGULAR ARM

Brackets for Non-Hold Open Arms

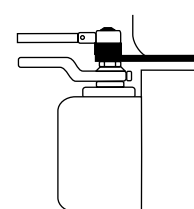
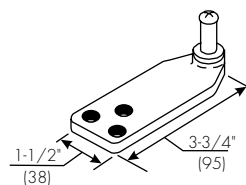
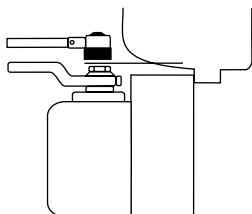
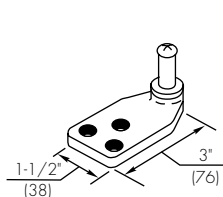

Molded/Bull Nose Trim - #2403B Bracket: For use where the door frame has molded or bull nose trim which will not accept a standard non-hold open shoe. The bracket is mortised into the frame rabbet, and projects beyond the face of the frame. It will accommodate a frame rabbet up to 2" (51mm) deep.

Molded / Bull Nose Trim - #2403-3/4 Bracket: This bracket is similar to, but longer than, the 2403B bracket. It is designed to accommodate frame rabbets from 2" to 2-7/8" (51 to 73mm) deep.

Brackets for Hold Open Arms

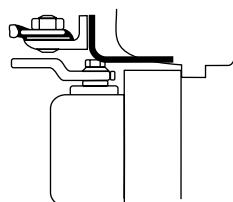
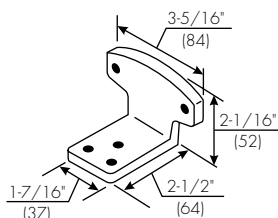

Molded / Bull Nose Trim - #80 Bracket: For use where the door frame has molded or bull nose trim which will not accept a standard hold open shoe. It is mortised into the frame rabbet, and projects beyond the face of the frame. It will accommodate a rabbet up to 2" (51mm) deep. This bracket is used in combination with the standard hold-open mounting shoe.

TOP JAMB ARM

Closer Mounting Plates Slim Line Installations

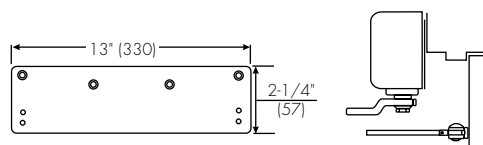

Low Ceiling Clearance - #8146 Drop Plate: For use where low ceiling clearance prevents normal top jamb mounting. This plate is used when clearance is from 1-7/8" to 2-7/8" (48 to 73mm). Where ceiling clearance is less than 1-7/8" (48mm) see #8148 Drop Plate on page 30.

Overhead Door Holder - #8146 Drop Plate: For use where a surface or concealed overhead door holder prevents normal top jamb mounting. This plate drops the closer and allows arm mounting screws to clear the bottom of the door holder. This places the centerline of the arm mounting screws at 2-7/8" (73mm) from the top of the door.

TOP JAMB ARM

Closer Mounting Plates Slim Line Installations

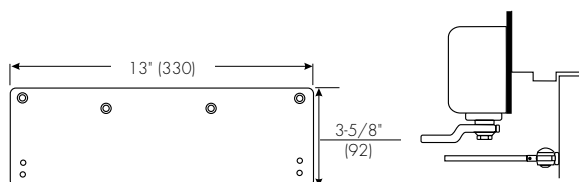

Low Ceiling Clearance - #8148 Drop Plate: For use where the ceiling clearance is between 1-1/2" and 1-3/4" (38 and 44mm).

Metal Cover Installations

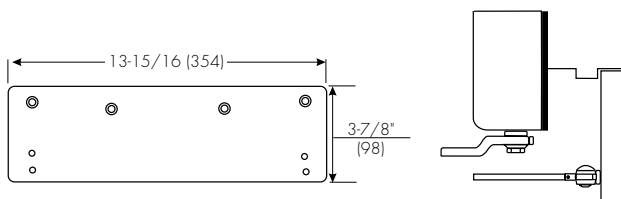

Low Ceiling Clearance - Overhead Door Holder -

#8547 Metal Full Cover Drop Plate: For use where a low ceiling clearance prevents normal top jamb mounting. This plate is used when the clearance is between 1-5/8" and 3-7/8" (41 and 98mm). Or for use where a surface or concealed overhead door holder prevents normal top jamb mounting of a

closer with a metal full cover. This plate drops the closer and allows arm mounting screws to clear the bottom of the door holder. This places the centerline of the arm mounting screws at 3-7/8" (98mm) from the top of the door.

Architectural Plastic or Metal Cover Installations

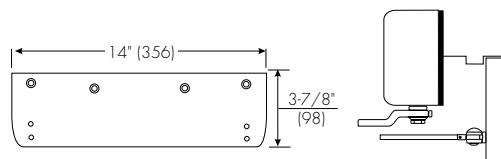

Low Ceiling Clearance - Overhead Door Holder -

#8547A Architectural Plastic or Architectural Metal Cover Drop Plate: For use where low ceiling clearance prevents normal top jamb mounting. This plate is used when the clearance is between 1-5/8" and 3-7/8" (41 and 98mm). Also for use where a surface or concealed overhead door holder prevents normal top jamb mounting of a closer with an

architectural plastic or metal full cover. This plate drops the closer and allows arm mounting screws to clear the bottom of the door holder. This places the centerline of the arm mounting screws at 3-7/8" (98mm) from the top of the door.

PARALLEL ARM

Closer Mounting Plates Slim Line Installations

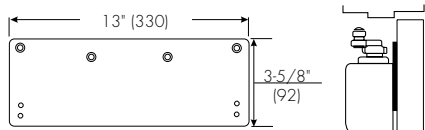

Narrow Top Rail - #8148 Drop Plate: For use where a narrow top rail prevents the closer from being mounted directly to the door surface. This drop plate can be used to mount a closer on a top rail as narrow as 2-7/8" (73mm) in height.

Full Cover Installations

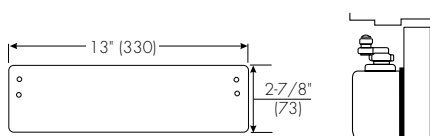

Exposed Back - #8445 Molded Full Cover Decorative Back Plate: For use on doors with glass lights where a closer with molded full cover is installed and the closer back is exposed. This plate covers the back of the installation to give a pleasing appearance from the reverse side.

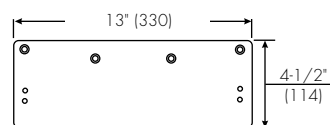

Exposed Back/Narrow Top Rail - #8158 Molded Full Cover Drop Plate: For use on doors with glass lights where a closer with molded full cover is installed and the back of the closer is exposed. This covers the back of the installation and gives a pleasing appearance from the reverse side.

Metal Cover Installations

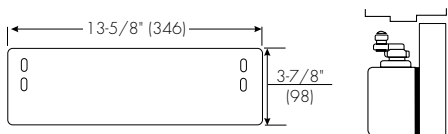

Exposed Back - #8545 Metal Full Cover Decorative Back Plate: For use on doors with glass lights where a closer with full metal cover is installed and the back of the closer is exposed. This plate covers the back of the installation and gives a pleasing appearance from the reverse side.

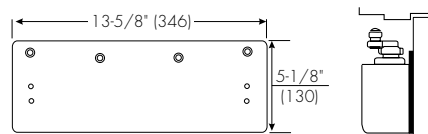

Exposed Back/Narrow Top Rail - #8548 Metal Full Cover Drop Plate: For use on doors with glass lights where a closer with metal full cover is installed on a narrow top rail, and the back of the cover is exposed. This drop plate can be used to mount a closer on a top rail as narrow as 2-7/8" (73mm) in height. This plate covers the back of the installation and gives a pleasing appearance from the reverse side.

Architectural Plastic or Metal Cover Installations

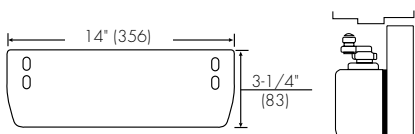

Exposed Back - #8545A Architectural Plastic or Architectural Metal Cover Decorative Back Plate: For use on doors with glass lights where a closer with an architectural plastic or metal cover is installed and the closer back is exposed. This plate covers the back of the installation to give a pleasing appearance from the reverse side.

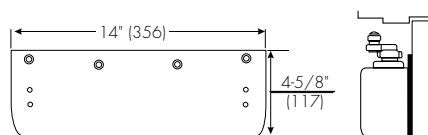

Exposed Back/Narrow Top Rail - #8548A Architectural Plastic or Architectural Metal Cover Drop Plate: For use on doors with glass lights where a closer with an architectural plastic or metal cover is installed on a narrow top rail, and the back of the cover is exposed. This drop plate can be used to mount a closer on a top rail as narrow as 2-7/8" (73mm) in height. This plate covers the back of the installation to give a pleasing appearance from the reverse side.

PARALLEL ARM

Brackets for Non-Hold Open Arms

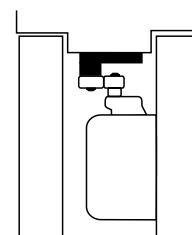
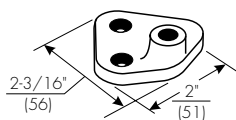
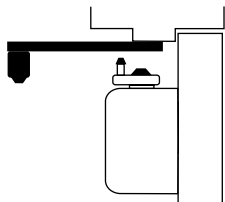
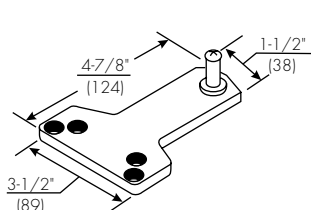

Standard Installation - #1618A Soffit Plate: This soffit plate is supplied standard with parallel arm closers. It can be mounted where the frame soffit is as narrow as 1" (25 mm).

Mounting between Doors - #2018 Soffit Bracket: For use where insufficient space between companion doors does not permit use of other soffit plates. This bracket permits mounting of the closer between doors with as little as 3" (76mm) of header space. Permits closer arm to clear up to 5/8" (16mm) high stop.

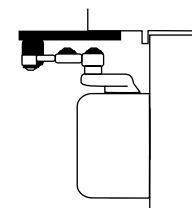
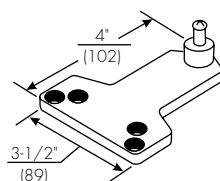
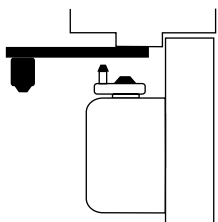
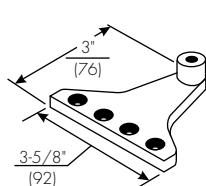

Narrow Frame/Removable Stop - #2018B Soffit Plate: For use where a narrow frame or frame with removable stop does not permit use of the standard soffit plate. This soffit plate may be mounted on the frame soffit or the frame rabbet where the stop does not exceed 5/8" (16mm) in height. All of the screw holes are in a straight line, requiring as little as 1-1/4" (32mm) of frame reveal to mount bracket and maintain good closer arm geometry. Where the frame soffit is as wide as 2" (51mm), this soffit plate may be used to clear weather-stripping that is up to 1-3/8" (35mm) wide and 5/8" (16mm) in height.

Blade/Applied Stop - #2018D Soffit Plate: For use where a blade or applied stop does not permit installation of the standard soffit plate. Mounts to either the frame soffit or rabbet. Since this soffit plate projects 7/8" (22mm) less than a standard soffit plate, it requires a minimum frame reveal of 1-1/2" (38mm). Permits closer to clear up to a 5/8" (16mm) stop.

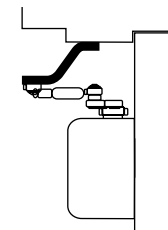
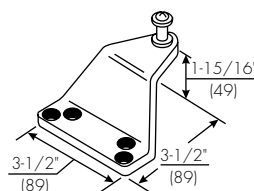
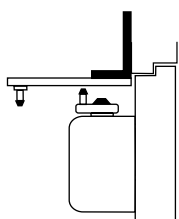
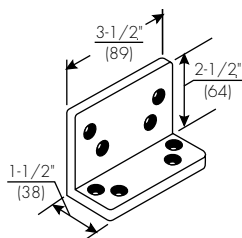

Flush Transom - #2022 Angle Bracket: For use where rabbeted or flush transom conditions prevent installation of a soffit plate. Used in combination with the 1618 soffit plate, or may be used in combination with the 2018S soffit plate when it is necessary for the closer arm to clear a separate overhead door holder.

Extra-Clearance - #2018S Offset Soffit Plate: For use where the need for additional clearance prevents use of the standard soffit plate. This plate mounts to the frame soffit to provide up to 2" (51mm) of clearance when a separate overhead door holder is used. Standard mounting requires a 2-5/8" (67mm) wide frame soffit. It may also be used where unusually high frame stops or weather-stripping prevent the use of other soffit plates.

PARALLEL ARM

Brackets for Non-Hold Open & Hold Open Arms

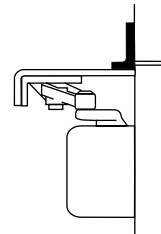
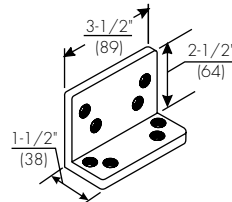
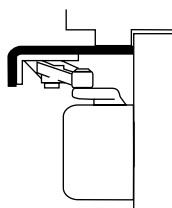
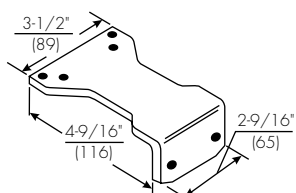

Parallel Hold-Open - #1628H Adapter Plate: Supplied standard with all parallel arm hold open closers. It can also be used to convert regular arm or top jamb hold open arms to parallel arm installation. It can be mounted where the frame soffit is as narrow as 1" (25mm).

Flush Transom - #2022 Angle Bracket: For use where rabbeted or flush transom conditions prevent installation of a soffit plate. Used in combination with the 1628H adapter plate, this bracket fastens to the overhead transom to provide a mounting surface for the soffit plate assembly.

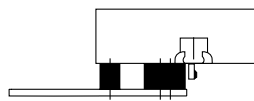
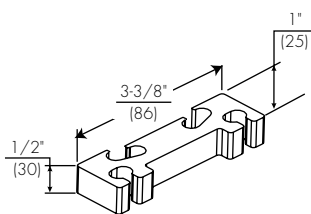

Clearance/Support Blade Stop - #6891 Spacer Block: For use where the door frame has a blade stop and the soffit plate must be mounted on the frame rabbet. This accessory is used in combination with the standard spacer block to provide clearance of the blade stop. Also used with non-hold open arms.

PR, CLP & CPS ARMS

Closer Mounting Plates
Slim Line Installations

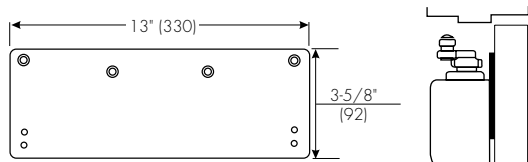

Narrow Top Rail - #8148 Drop Plate: For use where a narrow top rail prevents the closer from being mounted directly to the door surface. This drop plate can be used to mount a closer on a top rail as narrow as 2-9/16" (65mm) in height.

Full Cover Installations

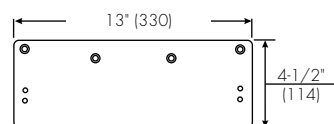
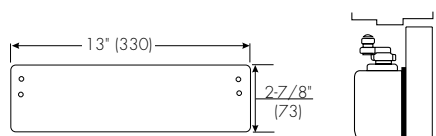

Exposed Back - #8445 Molded Full Cover Decorative Back Plate: For use on doors with glass lights where a closer with molded full cover is installed and the closer back is exposed. This plate covers the back of the installation to give a pleasing appearance from the reverse side.

Exposed Back/Narrow Top Rail - #8158 Molded Full Cover Drop Plate: For use on doors with glass lights where a closer with molded full cover is installed and the back of the closer is exposed. This covers the back of the installation and gives a pleasing appearance from the reverse side.

Metal Cover Installations

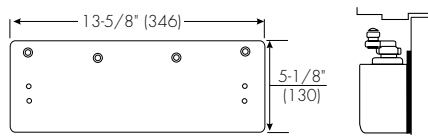
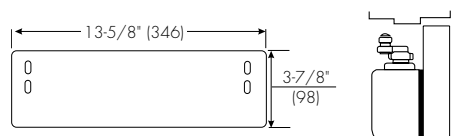

Exposed Back - #8545 Metal Full Cover Decorative Back Plate: For use on doors with glass lights where a closer with full metal cover is installed and the back of the closer is exposed. This plate covers the back of the installation and gives a pleasing appearance from the reverse side.

Exposed Back/Narrow Top Rail - #8548 Metal Full Cover Drop Plate: For use on doors with glass lights where a closer with metal full cover is installed on a narrow top rail, and the back of the cover is exposed. This drop plate can be used to mount a closer on a top rail as narrow as 2-9/16" (65mm) in height. This plate covers the back of the installation and gives a pleasing appearance from the reverse side.

Architectural Plastic or Metal Cover Installations

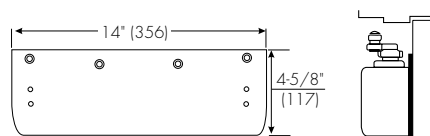
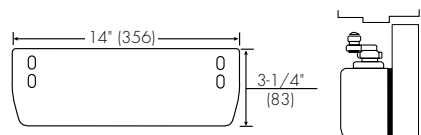

Exposed Back - #8545A Architectural Plastic or Architectural Metal Cover Decorative Back Plate: For use on doors with glass lights where a closer with an architectural plastic or metal cover is installed and the closer back is exposed. This plate covers the back of the installation to give a pleasing appearance from the reverse side.

Exposed Back/Narrow Top Rail - #8548A Architectural Plastic or Architectural Plastic or Architectural Metal Cover Drop Plate: For use on doors with glass lights where a closer with an architectural plastic or metal cover is installed on a narrow top rail, and the back of the cover is exposed. This drop plate can be used to mount a closer on a top rail as narrow as 2-9/16" (65mm) in height. This plate covers the back of the installation to give a pleasing appearance from the reverse side.

PR, CLP & CPS ARMS

Brackets for Non-Hold Open Arms & Hold Open Arms

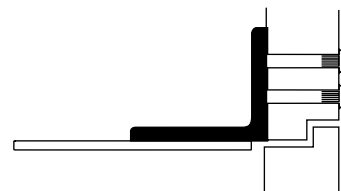
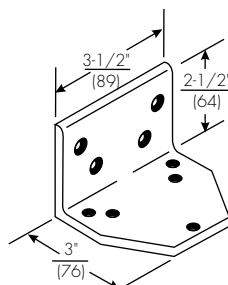
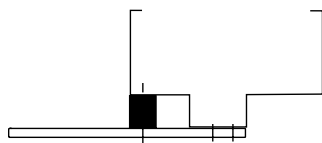
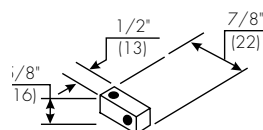

Standard - #2019S Spacer Block: For use where a narrow frame soffit does not provide adequate support for the soffit plate. Supplied as standard with all parallel rigid arm closers.

Flush Rabbeted Transom - #2019L Angle Bracket: For use where flush transom conditions prevent mounting of the standard soffit plate. This bracket is used in combination with the standard soffit plate.

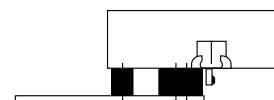
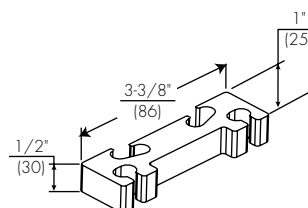
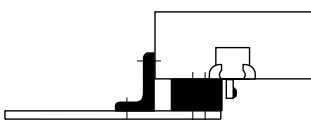
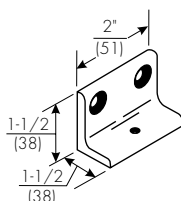

Narrow Frame - #6890 Support Bracket: For use where the frame is narrow and the soffit plate cannot be mounted directly to the frame soffit or rabbet. Used in combination with the #6891 Spacer Block on blade stop frames to provide extra support and needed clearance of the blade stop. Used on frames where the frame stop does not exceed 5/8 inch (16mm) in height.

Clearance/Support Blade Stop - #6891 Spacer Block: For use where the door frame has a blade stop and the soffit plate must be mounted on the frame rabbet. This accessory is used in combination with the standard spacer block to provide clearance of the blade stop.

UNITROL® ARM

Closer Mounting Plates
Parallel Arm

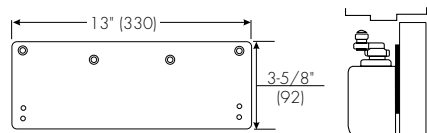

Narrow Top Rail - #8148 Drop Plate: For use where a narrow top rail prevents the closer from being mounted directly to the door surface. This drop plate can be used to mount a closer on a top rail as narrow as 2-7/16" (62mm) in height.

Full Cover Installations

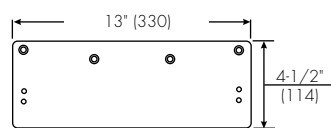
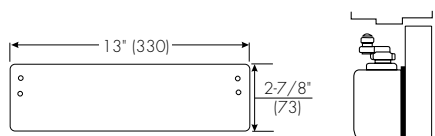

Exposed Back - #8445 Molded Full Cover Decorative Back Plate: For use on doors with glass lights where a closer with molded full cover is installed and the closer back is exposed. This plate covers the back of the installation to give a pleasing appearance from the reverse side.

Exposed Back/Narrow Top Rail - #8158 Molded Full Cover Drop Plate: For use on doors with glass lights where a closer with molded full cover is installed and the back of the closer is exposed. This covers the back of the installation and gives a pleasing appearance from the reverse side.

Metal Cover Installations

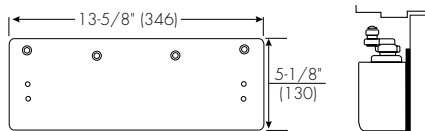
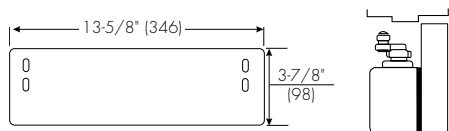

Exposed Back - #8545 Metal Full Cover Decorative Back Plate: For use on doors with glass lights where a closer with full metal cover is installed and the back of the closer is exposed. This plate covers the back of the installation and gives a pleasing appearance from the reverse side.

Exposed Back/Narrow Top Rail - #8548 Metal Full Cover Drop Plate: For use on doors with glass lights where a closer with metal full cover is installed on a narrow top rail, and the back of the cover is exposed. This drop plate can be used to mount a closer on a top rail as narrow as 2-9/16" (65mm) in height. This plate covers the back of the installation and gives a pleasing appearance from the reverse side.

Architectural Plastic or Metal Cover Installations

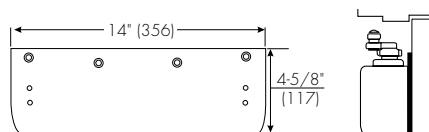
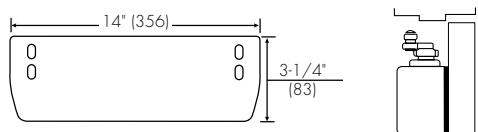

Exposed Back - #8545A Architectural Plastic or Architectural Metal Cover Decorative Back Plate: For use on doors with glass lights where a closer with an architectural plastic or metal cover is installed and the closer back is exposed. This plate covers the back of the installation to give a pleasing appearance from the reverse side.

Exposed Back/Narrow Top Rail - #8548A Architectural Plastic or Architectural Plastic or Architectural Metal Cover Drop Plate: For use on doors with glass lights where a closer with an architectural plastic or metal cover is installed on a narrow top rail, and the back of the cover is exposed. This drop plate can be used to mount a closer on a top rail as narrow as 2-7/16" (62mm) in height. This plate covers the back of the installation to give a pleasing appearance from the reverse side.

UNITROL® ARM

Closer Mounting Plate

Soffit Plate Reinforcing Brackets (for Parallel Arm)

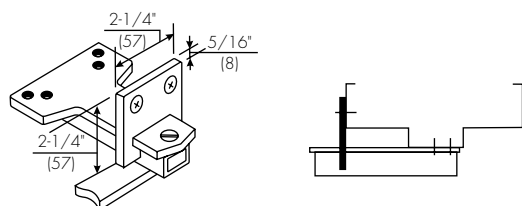

Additional Support - #6190 Reinforcing Bracket: Standard for use with all parallel arm *Unitrol* door controls. Provides additional support to the soffit plate on installations with door frame reveals from 1-7/8" to 4-5/8" (48 to 117mm).

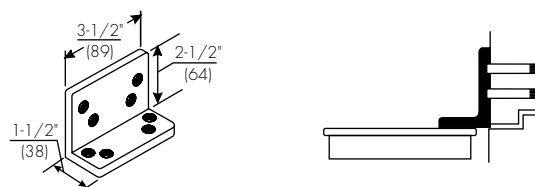

Flush Rabbeted Transom - #2022 Angle Bracket: Optional for use with all parallel arm *Unitrol* door controls. For use where rabbeted or flush transom conditions prevent installation of the soffit plate assembly. This bracket fastens to the overhead transom to provide a mounting surface for the soffit plate assembly.

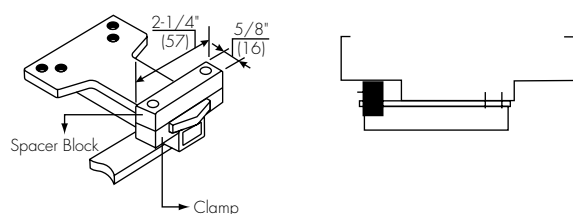

Wide Frame - #6191 Reinforcing Kit: Optional for use with all parallel arm *Unitrol* door controls. Used to support the soffit plate on installations with wide frames. Clamps may be used with or without the spacer block, depending on frame conditions.

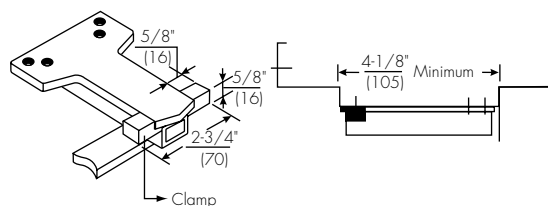

UNITROL® ARM

Closer Mounting Plates
Top Jamb

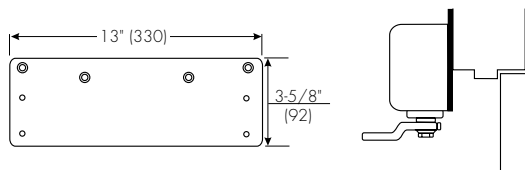

Narrow Top Rail - #8148 Drop Plate: For use where a narrow top rail prevents the closer from being mounted directly to the door surface. This drop plate can be used to mount a closer on a top rail as narrow as 2-7/16" (62mm) in height.

Full Cover Installations

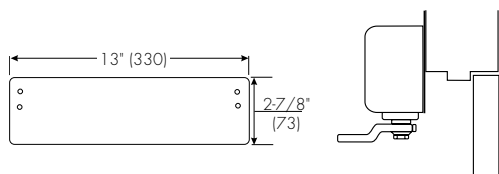

Exposed Back - #8445 Molded Full Cover Decorative Back Plate: For use on doors with glass lights where a closer with molded full cover is installed and the closer back is exposed. This plate covers the back of the installation to give a pleasing appearance from the reverse side.

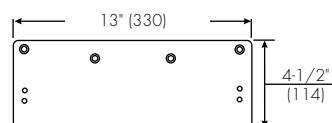

Exposed Back/Narrow Top Rail - #8158 Molded Full Cover Drop Plate: For use on doors with glass lights where a closer with molded full cover is installed and the back of the closer is exposed. This covers the back of the installation and gives a pleasing appearance from the reverse side.

Metal Cover Installations

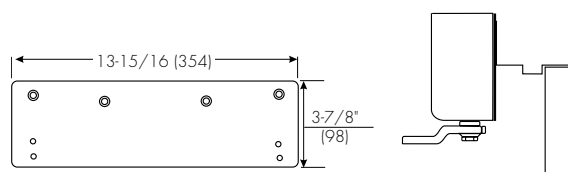

Low Ceiling Clearance - Overhead Door Holder - #8547 Metal Full Cover Drop Plate: For use where a low ceiling clearance prevents normal top jamb mounting. This plate is used when the clearance is between 1-5/8" and 3-3/4" (41 and 95mm). Or for use where a surface or concealed overhead door holder prevents normal top jamb mounting of a closer with a metal full cover. This plate drops the closer and allows arm mounting screws to clear the bottom of the door holder. This places the centerline of the arm mounting screws at 3-7/8" (98mm) from the top of the door.

Architectural Plastic or Metal Cover Installations

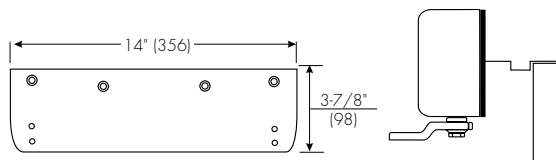

Low Ceiling Clearance - Overhead Door Holder - #8547A Architectural Plastic or Architectural Metal Cover Drop Plate: For use where low ceiling clearance prevents normal top jamb mounting. This plate is used when the clearance is between 1-5/8" and 3-3/4" (41 and 95mm). Or for use where a surface or concealed overhead door holder prevents normal top jamb mounting of a closer with an architectural plastic or metal full cover. This plate drops the closer and allows arm mounting screws to clear the bottom of the door holder. This places the centerline of the arm mounting screws at 3-7/8" (98mm) from the top of the door.

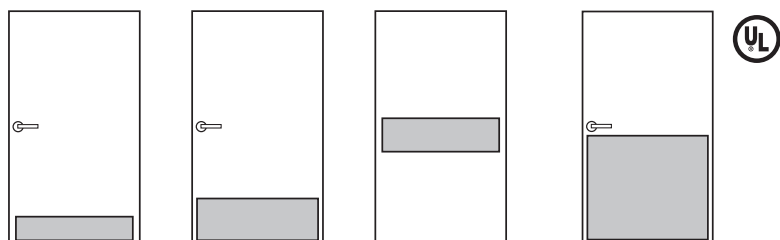

Mop Plate
Up to 6" h x 48" w

Kick Plate
6" to 12" h x 48" w

Stretcher Plate
6" to 12" h and up to 48" w

Armor Plate
Up to 48" h x 48" w and available in most finishes

OPTIONAL Self-Drilling TEK Screws: Cuts door plate installation time in half.

Width of Plates:

Push Side: 2" less than door width.

Pull Side: 1½" less than door width.

NFPA 80 STANDARDS — 2-4.5 Protection Plates:

Factory-installed protection plates shall be installed in accordance with the listing of the door. Field-installed protection plates shall be labeled and installed in accordance with their listing.

Exception: Labeling is not required where the top of the protection plate is not more than 16" (406 mm) above the bottom of the door.

Metal Door Plate – Economy Duty No. K1038

Material: .038" aluminum, stainless steel

Finishes: US32D

Fastener: #6 x 5/8" OH SMS

Ordering: Specify height x width x finish code. Add any options

Weight: 8" x 34" = 3.2 lbs

- Options:**
- SA – self-adhesive mounting
 - TORX – security Torx screws
 - TEK – self-drilling screws
 - Cutouts for locks, louvers, or windows (see worksheets on pages C14-C15 for details on how to order)

Metal Door Plate - Standard Duty No. K1050

Material: .050" Stainless Steel

Finishes: US32D

Fastener: #6 x 5/8" OH SMS

Ordering: **Size** **High** **Width**

8x34BEV.32D 8" 34"

10x34BEV.32D 10" 34"

34x34BEV.32D 34" 34"

- Options:**
- Beveled Edge and Counter Sink included
 - One day shipping available
 - Door markings are not available on quick ship

Metal Door Plate – Standard Duty No. K1050, K1050F

Material: .050" aluminum, brass, bronze, stainless steel

Finishes: US10BE, US32D, US32DMS

Fastener: #6 x 5/8" OH SMS

Ordering: Specify height x width x finish code. Add any options

Weight: 8" x 34" = 4.0 lbs

ANSI: J101 - metal armor plate, J102 - metal kick plate, J103 - metal stretcher & mop plate

- Options:**
- SA – self-adhesive mounting
 - TEK – self-drilling screws
 - Beveled 3 or 4 edges, specify B3E or B4E
 - Cutouts for locks, louvers, or windows (see worksheets on pages C14-C15 for details on how to order)
 - Heavy bevel available, specify HVBEV
 - Screw mounting (K1050F) and UL listed for use on 90-minute label wood doors and 3-hour label metal doors
 - CSK – countersunk holes
 - TORX – security Torx screws

Windstorm Plate – K1050WS

Material: .050" Aluminium, Brass, Bronze, Stainless Steel

Finishes: Standard Architectural Finishes

Fastener: #10x5/8" Pan Head Tek Screws

Ordering: Part # when ordering is K1050WS

All plates are UL and Windstorm rated

- Options:**
- Cutouts for locks, louvers or windows
 - Rounded Corners
 - Heavy Bevel
 - Screw Mount only

Certified to the below standards:

- ICC-500 (2014)

- FEMA Guideline 320 (2014)

- FEMA Guideline 361 (2015)

Part of windstorm assembly cards: ZHLA.45, ZHLA.46, ZHLA.47, ZHLA.51, ZHLA.53, ZHLA.54

800-458-2424 | www.assaabloydooraccessories.us

Check the web site for the up-to-date catalog

Copyright © 2012-2019, ASSA ABLOY Accessories and Door Controls Group, Inc. All rights reserved. Reproduction in whole or in part without the express written permission of ASSA ABLOY Accessories and Door Controls Group, Inc. is prohibited.

ASSA ABLOY
Opening Solutions

Experience a safer
and more open world



Solid Cast Wall Stops No. 400, 401, 402

Material: Cast brass with DuraFlex bumper

Finishes: Available in standard architectural finishes (see page 9)

Features: Concealed mounting, convex bumper. Back plate prevents damage to wall

No.	Bumper	Fastener	Size	Projection	Weight	ANSI A156.16
400	Convex	#6 x 1½" FH SMS, plastic toggle	2⅞" dia.	1"	3.3 lbs./10	L02101
401	Convex	#8 x 1" RH WS, plastic anchor	2⅞" dia.	1"	3.3 lbs./10	L02101
402	Convex	#8 - 32 x 1" TH MS, lead anchor	2⅞" dia.	1"	3.3 lbs./10	L02101



Solid Cast Wall Stops No. 403, 404, 405

Material: Cast brass with DuraFlex bumper

Finishes: Available in standard architectural finishes (see page 9)

Features: Concealed mounting, concave bumper. Back plate prevents damage to wall

No.	Bumper	Fastener	Size	Projection	Weight	ANSI A156.16
403	Concave	#6 - 1½" FH SMS, plastic toggle	2⅞" dia.	1"	3.3 lbs./10	L02251
404	Concave	#8 x 1" RH WS, plastic anchor	2⅞" dia.	1"	3.3 lbs./10	L02251
405	Concave	#8 - 32 x 1" TH MS, lead anchor	2⅞" dia.	1"	3.3 lbs./10	L02251



Wrought Wall Stops No. 406

Material: Wrought brass, bronze, and stainless steel with DuraFlex bumper

Finishes: Available in standard architectural finishes (see page 9)

Features:

- Concealed mounting, convex bumper. Back plate prevents damage to wall
- Accepted by the New York State Office of Mental Health (OMH) for use in high risk areas

No.	Bumper	Fastener	Size	Projection	Weight	ANSI A156.16
406	Convex	#8 x 1¼" TH SMS, plastic toggle	2½" dia.	¾"	1.8 lbs./10	L02101



Wrought Wall Stops No. 409

Material: Wrought brass, bronze, and stainless steel with DuraFlex bumper

Finishes: Available in standard architectural finishes (see page 9)

Features:

- Concealed mounting, concave bumper. Back plate prevents damage to wall
- Accepted by the New York State Office of Mental Health (OMH) for use in high risk area

Options: DuraFlex bumper available in standard gray or optional black

No.	Bumper	Fastener	Size	Projection	Weight	ANSI A156.16
409	Concave	#8 x 1¼" TH SMS, plastic toggle	2½" dia.	¾"	1.8 lbs./10	L02251

ASSA ABLOY

The global leader in
door opening solutions

Kerf-In Weatherstrip (Cont.)

PK52_

AVAILABLE FINISHES: **BL, W**

ANSI: **R0G154**

AVAILABLE LENGTHS: **18', 20', 300'**

- Minimum space between the door face and the stop is $\frac{1}{16}$ "; maximum space is $\frac{3}{8}$ "

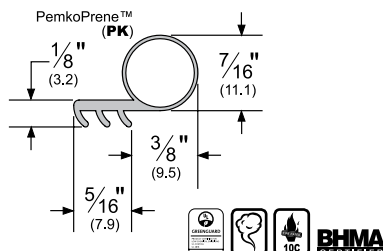

P50_

AVAILABLE FINISHES: **BL, W**

AVAILABLE LENGTHS: **17', 25', 250'**

- Minimum space between the door face and the stop is $\frac{1}{16}$ "; maximum space is $\frac{1}{16}$ ".
- Thermoplastic elastomer formulation will not transmigrate; remains flexible to -60° F

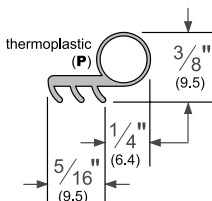

MAG349_

AVAILABLE FINISHES: **D, W**

AVAILABLE LENGTHS: **37", 85", 96", 121"**

- Minimum space between the door face and the stop is $\frac{3}{8}$ "; maximum space is $\frac{7}{16}$ ".
- Magnetic kerf-in weatherstrip features a magnetic strip encased by a UV-stable TPE cover
- Use for steel-faced door and wood frame applications
- Can be trimmed in the field and corner-mitered

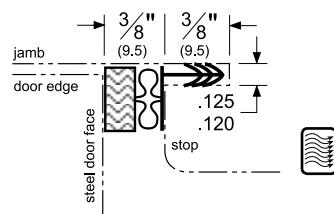

Magnetic Kerf-In Weatherstrip

2815_M

AVAILABLE FINISHES: **C, D, G**

REPLACEMENT INSERT: **2815MAG**

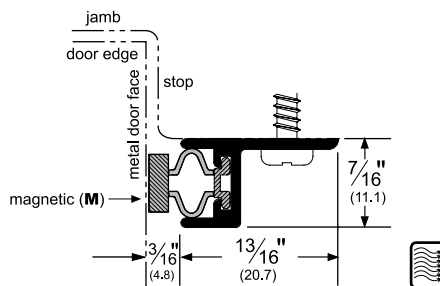

Adhesive Perimeter Gasketing

For more information on these perimeter gasketing products, please see the Adhesive Gasketing section.

S773_

AVAILABLE FINISHES: **BL, D, GR, W**

AVAILABLE LENGTHS: **17', 18', 20', 21', 25', 30', 250', 500'**

ANSI: **R0E154, R0E155**

- Triple-fin design blocks light and sound from infiltrating a room
- Product designed as hospitality gasketing (see more hospitality products in the Hospitality Products section)
- Seal begins compressing at $\frac{3}{8}$ "; compresses to seal up to a $\frac{1}{16}$ " gap

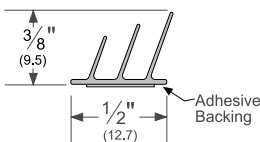

S88_

AVAILABLE FINISHES: **BL, C, D, GR, TAN, W**

AVAILABLE LENGTHS: **17', 18', 20', 21', 25', 30', 204', 510'**

ANSI: **R0E154, R0E155**

- Seal begins compressing at $\frac{1}{4}$ "; compresses to seal up to a $\frac{1}{16}$ " gap
- Available with perforations for Behavioral Health applications. Substitute "P" in place of "S" to order this option.

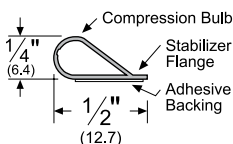

S44_

AVAILABLE FINISHES: **BL, C, D, GR, W**

AVAILABLE LENGTHS: **17', 18', 20', 21', 25', 30', 204', 510'**

ANSI: **R0E154, R0E155**

- Designed for tighter frames.
- Demonstrates extremely low closing force.
- Seal begins compressing at $\frac{5}{16}$ "; compresses to seal up to a $\frac{1}{16}$ " gap
- Available with perforations for Behavioral Health applications. Substitute "P" in place of "S" to order this option.

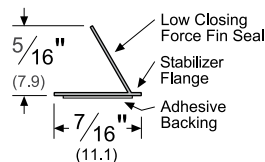

NOTE: Products shown in this section may not be drawn to scale.

AVAILABLE FINISHES FOR PRODUCTS SHOWN ON THIS PAGE (see General Information section for finish chart)

Adhesive Gasketing Colors: **BL** (Black) **C** (Clear) **D** (Dark Brown) **GR** (Light Gray) **TAN** (Tan) **W** (White)

ASSA ABLOY

The global leader in
door opening solutions

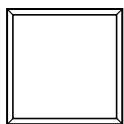

Wall Guard No. 606

- Material:** Clear rubber
- Other:** Sold in sheets of 55
- Features:** Self-adhesive mounting

No.	Fastener	Size	Weight
606	Self-adhesive back	1" x 1"	0.4 lbs./55

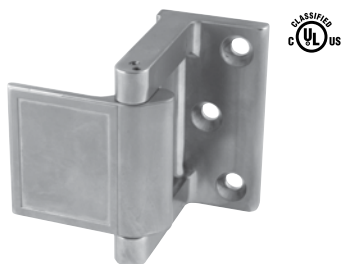

Privacy Door Latch No. PDL (formerly 607)

- Material:** Zinc die cast
- Finishes:** BRS, DBRS, STNN, CRM, DCRM, ORB
- Features:**
- ADA compliant
 - Enhanced in room privacy
 - Easy to install
 - For use with UL Classified fire doors for use with hollow metal steel composite type fire doors rated up to and including 3 hrs
 - Wood composite type fire doors rated up to and including 1½ hrs and 20 minutes without hose stream

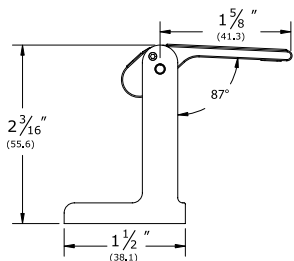

No.	Fastener	Size	Weight
PDL	#12 x 1¼" FH SMS	1½" x 2¹³⁄₁₆"	0.75 lbs.



Door Silencer No. 608CA

- Material:** Clear rubber
- Other:** Sold in packages of 300
- Features:** Self-adhesive mounting

No.	Fastener	Size	Weight
608CA	⅜" dia. x 1/8"	Metal or wood	0.2 lbs./300

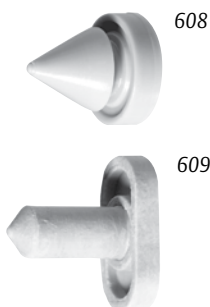

Door Silencers No. 608, 609

- Material:** DuraFlex gray rubber
- Other:** Sold in packages of 100

No.	Size	Frame Type	Weight	ANSI A156.16
608	½" dia. x 5/8"	Metal	1.3 lbs./500	L03011
609	⅜" x 3/4"	Wood	1.3 lbs./500	L03021

ASSA ABLOY

The global leader in
door opening solutions

Combination Strike and Stop

Recommended for installations on hospital or nursing home bathroom doors along with our EP-5J. This unit allows center hung or $\frac{1}{8}$ " inset doors to be opened in both directions without damaging the frame.

- Manufactured for use with cylindrical or bored locks
- Available in offset or center hung latch bolt location for frame sizes $5\frac{3}{4}$ ", $5\frac{7}{8}$ " and $6\frac{3}{4}$ "
- Custom units available for frame sizes $3\frac{1}{2}$ " to 10" consult factory for availability
- For use on $1\frac{3}{4}$ " thick doors
- Cannot be used with deadbolts. May not work with mortise locks. Consult the factory for mortise lock application of CORBIN RUSSWIN, SARGENT and YALE compatibility
- All Combination Strike and Stops are packed with $\frac{1}{2}$ x 8-32 machine screws
- Available in brass material polished and plated 26D

CSS-9
Offset Hung

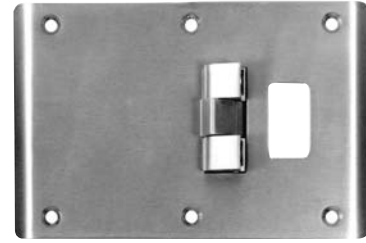

CSS-9
Center Hung

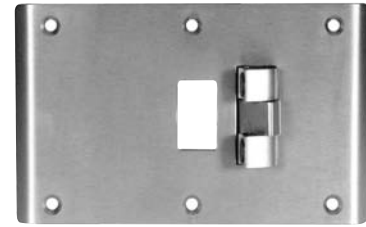

No.	ANSI Cross Reference	Base Material
CSS-9	A1882	Brass

Specifications

Inches	mm	Gauge	No. of Holes	Fasteners Machine
$5\frac{3}{4}$ "	146.1	.095	6	$\frac{1}{2}$ x 8-32
$5\frac{7}{8}$ "	149.2	.095	6	$\frac{1}{2}$ x 8-32
$6\frac{3}{4}$ "	171.5	.095	6	$\frac{1}{2}$ x 8-32

Application

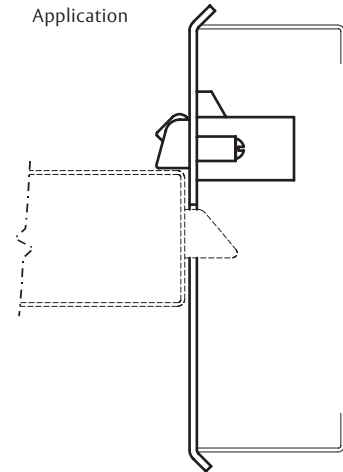

ASSA ABLOY
Opening Solutions

Experience a safer
and more open world

800-346-7707 | www.assaabloydooraccessories.us
Check the web site for the up-to-date catalog

McKinney is a brand associated with ASSA ABLOY Accessories and Door Controls Group, Inc., an ASSA ABLOY Group company. Copyright © 2012-2019, ASSA ABLOY Accessories and Door Controls Group, Inc. All rights reserved. Reproduction in whole or in part without the express written permission of ASSA ABLOY Accessories and Door Controls Group, Inc. is prohibited.